

L:
 CBL-PD302MBS-1m 1000mm±10mm
 CBL-PD302MBS-2m 2000mm±20mm
 CBL-PD302MBS-3m 3000mm±20mm

No	MATERIALS LIST:
1.	CABLE:UL2725 (28AWG*1PR+D+AM)x2C+28AWG*1PR+24AWG*1C+AM+B OD:5.6mm PVC JACKET COLOR:BLACK
2.	CONNECTOR:USB 3.0 A/M, 9P, BLUE INSULATOR SOLDER TYPE, NICKEL PLATED SHELL
3.	CONNECTOR:USB 3.0 MicroB/M, 10P, BLACK INSULATOR SOLDER TYPE, NICKEL PLATED SHELL
4.	PVC MOLDED HOUSING, BLACK COLOR
5.	SCREW:#4x33 M2

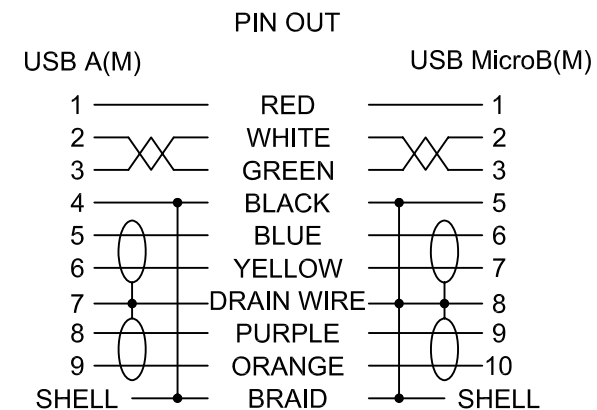

Jargy part no.	Client part no.	Approved	SCALE	UNIT
CBL-PD302MBS-Xm			1 : 1	mm
Drawing Name		Drawn	Date	REV.
USB 3.0 A to MicroB Cable M/M		<i>Kevin Hsu</i>	2015/08/25	1.0

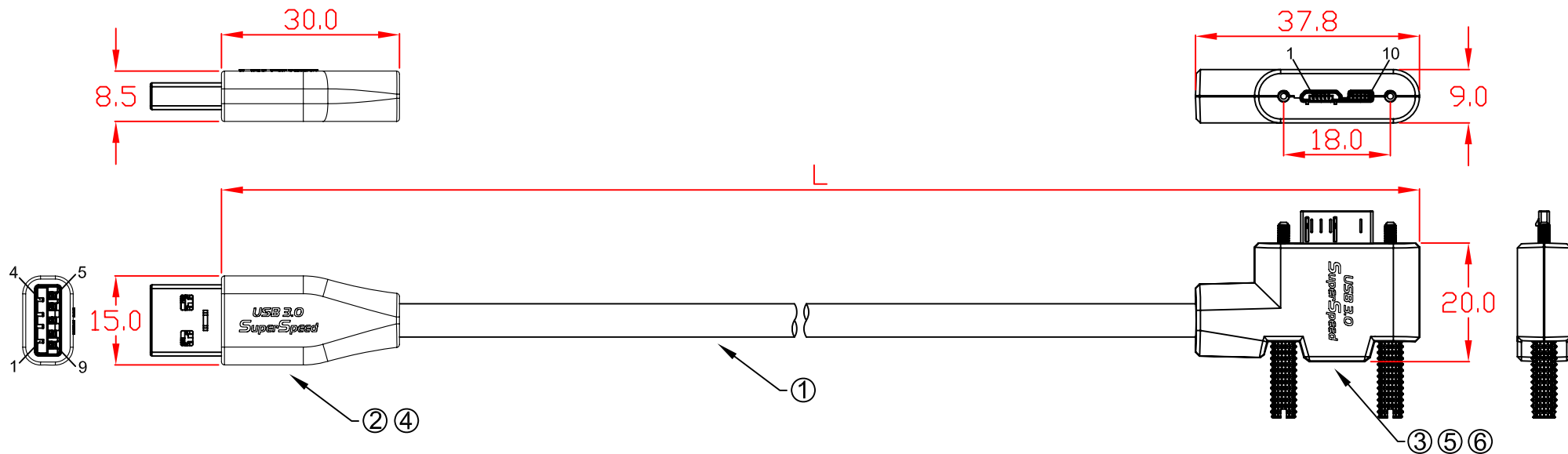

L:
 CBL-PD302MBS-1mLA 1000mm±10mm
 CBL-PD302MBS-2mLA 2000mm±20mm
 CBL-PD302MBS-3mLA 3000mm±20mm

No	MATERIALS LIST:
1.	CABLE:UL2725 (28AWG*1PR+D+AM)x2C+28AWG*1PR+24AWG*1C+AM+B OD:5.6mm PVC JACKET COLOR:BLACK
2.	CONNECTOR:USB 3.0 A/M, 9P, BLUE INSULATOR SOLDER TYPE, NICKEL PLATED SHELL
3.	CONNECTOR:USB 3.0 MicroB/M, 10P, BLACK INSULATOR SOLDER TYPE, NICKEL PLATED SHELL
4.	PVC MOLDED HOUSING, BLACK COLOR
5.	ABS ASSEMBLY HOUSING, BLACK COLOR
6.	SCREW:#4x33 M2

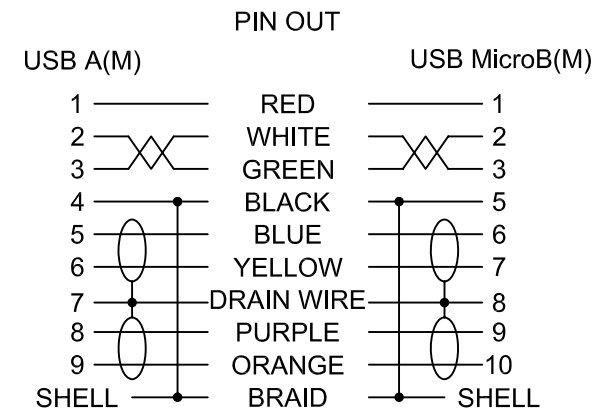

Jargy part no.	Client part no.	Approved	SCALE	UNIT
CBL-PD302MBS-XmLA			1 : 1	mm
Drawing Name		Drawn	Date	REV.
USB 3.0 A to MicroB Cable M/M		<i>Kevin Hsu</i>	2015/08/25	1.0

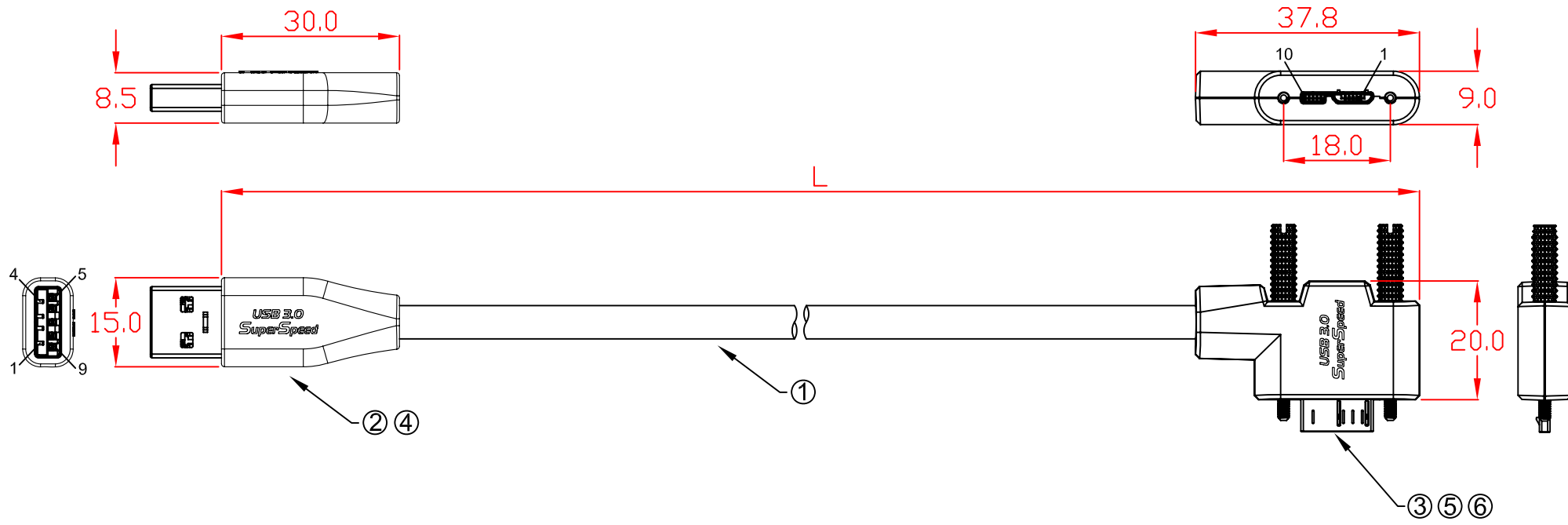

L:
 CBL-PD302MBS-1mRA 1000mm±10mm
 CBL-PD302MBS-2mRA 2000mm±20mm
 CBL-PD302MBS-3mRA 3000mm±20mm

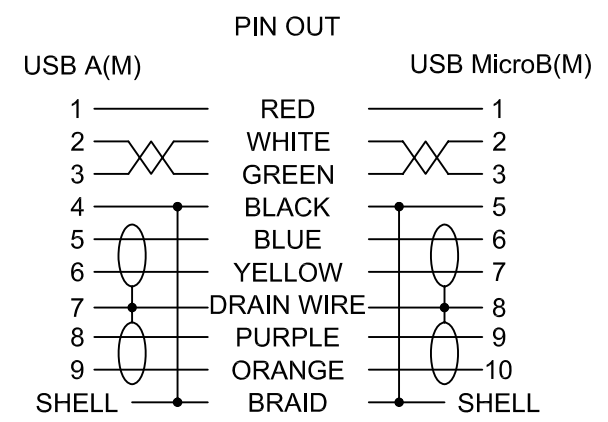

No	MATERIALS LIST:
1.	CABLE:UL2725 (28AWG*1PR+D+AM)x2C+28AWG*1PR+24AWG*1C+AM+B OD:5.6mm PVC JACKET COLOR:BLACK
2.	CONNECTOR:USB 3.0 A/M, 9P, BLUE INSULATOR SOLDER TYPE, NICKEL PLATED SHELL
3.	CONNECTOR:USB 3.0 MicroB/M, 10P, BLACK INSULATOR SOLDER TYPE, NICKEL PLATED SHELL
4.	PVC MOLDED HOUSING, BLACK COLOR
5.	ABS ASSEMBLY HOUSING, BLACK COLOR
6.	SCREW:#4x33 M2

Jargy part no.	Client part no.	Approved	SCALE	UNIT
CBL-PD302MBS-XmRA			1 : 1	mm
Drawing Name		Drawn	Date	REV.
USB 3.0 A to MicroB Cable M/M		<i>Kevin Hsu</i>	2015/08/25	1.0

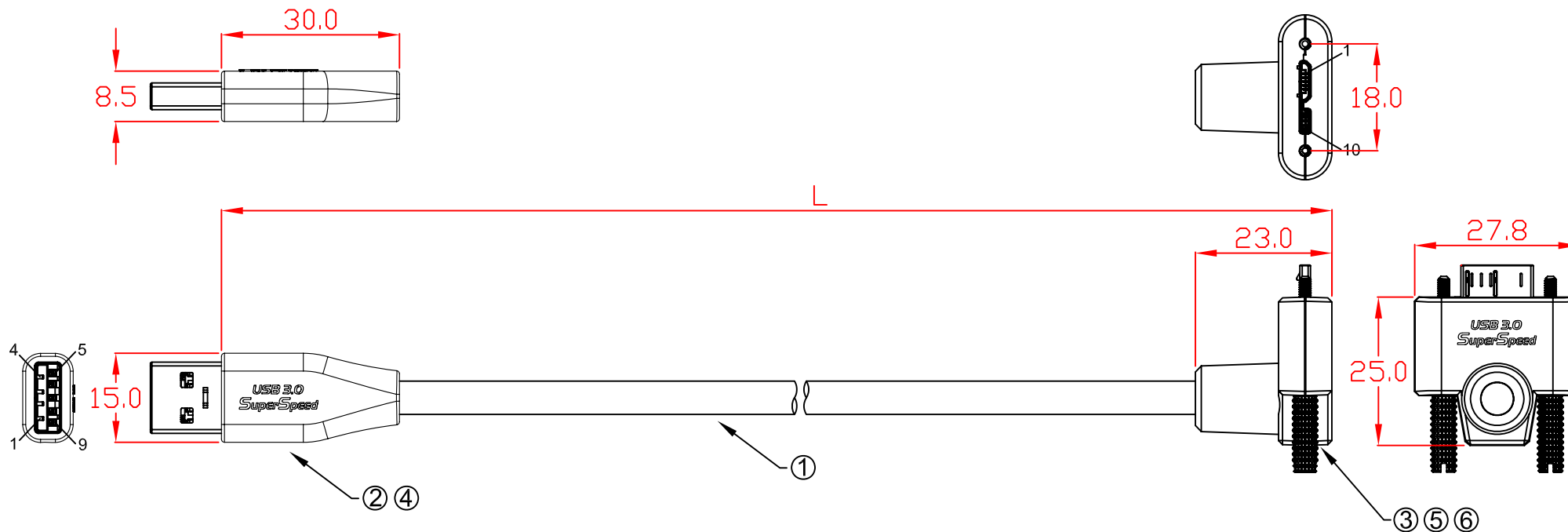

L:
 CBL-PD302MBS-1mUA 1000mm±10mm
 CBL-PD302MBS-2mUA 2000mm±20mm
 CBL-PD302MBS-3mUA 3000mm±20mm

PIN OUT

USB A(M)

USB MicroB(M)

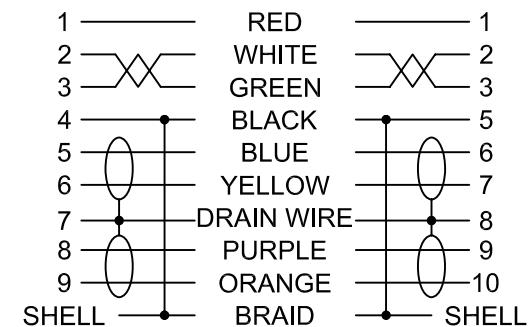

No	MATERIALS LIST:
1.	CABLE:UL2725 (28AWG*1PR+D+AM)x2C+28AWG*1PR+24AWG*1C+AM+B OD:5.6mm PVC JACKET COLOR:BLACK
2.	CONNECTOR:USB 3.0 A/M, 9P, BLUE INSULATOR SOLDER TYPE, NICKEL PLATED SHELL
3.	CONNECTOR:USB 3.0 MicroB/M, 10P, BLACK INSULATOR SOLDER TYPE, NICKEL PLATED SHELL
4.	PVC MOLDED HOUSING, BLACK COLOR
5.	ABS ASSEMBLY HOUSING, BLACK COLOR
6.	SCREW:#4x33 M2

Jargy part no.	Client part no.	Approved	SCALE	UNIT
CBL-PD302MBS-XmDA			1 : 1	mm
Drawing Name		Drawn	Date	REV.
USB 3.0 A to MicroB Cable M/M		<i>Kevin Hsu</i>	2015/08/25	1.0

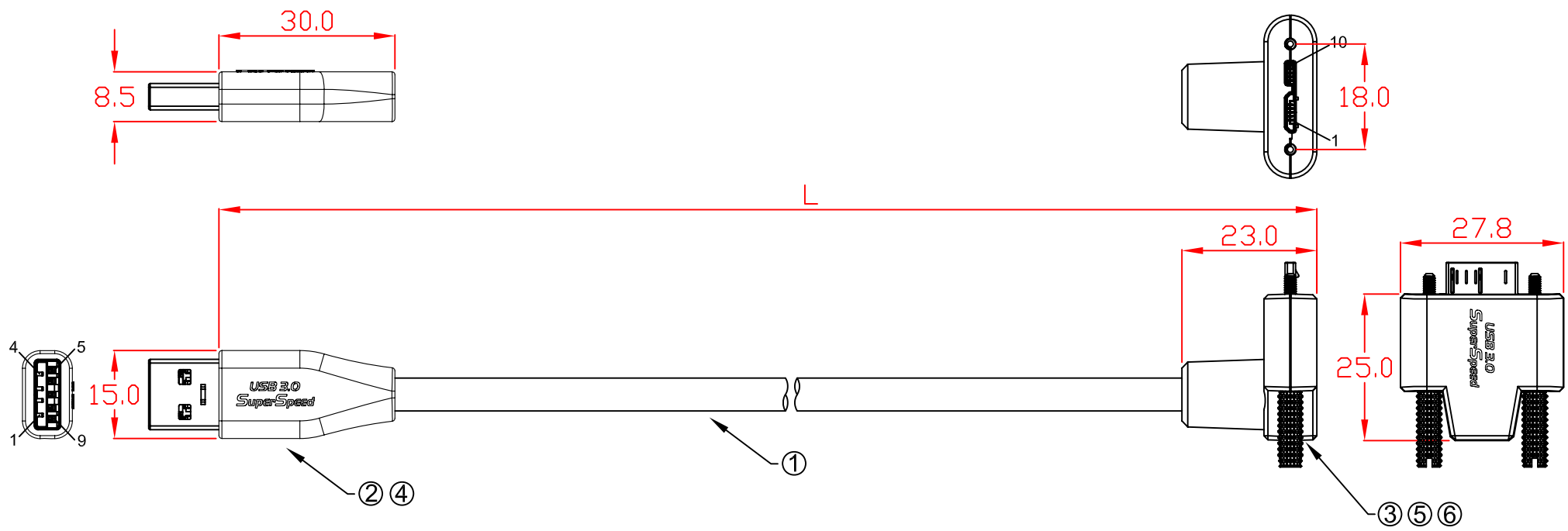

L:
 CBL-PD302MBS-1mDA 1000mm±10mm
 CBL-PD302MBS-2mDA 2000mm±20mm
 CBL-PD302MBS-3mDA 3000mm±20mm

PIN OUT

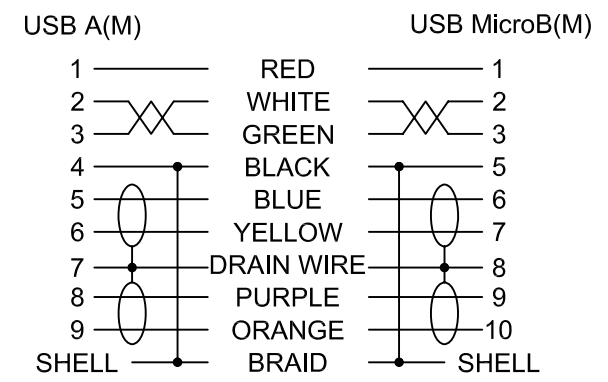

No	MATERIALS LIST:
1.	CABLE:UL2725 (28AWG*1PR+D+AM)x2C+28AWG*1PR+24AWG*1C+AM+B OD:5.6mm PVC JACKET COLOR:BLACK
2.	CONNECTOR:USB 3.0 A/M, 9P, BLUE INSULATOR SOLDER TYPE, NICKEL PLATED SHELL
3.	CONNECTOR:USB 3.0 MicroB/M, 10P, BLACK INSULATOR SOLDER TYPE, NICKEL PLATED SHELL
4.	PVC MOLDED HOUSING, BLACK COLOR
5.	ABS ASSEMBLY HOUSING, BLACK COLOR
6.	SCREW:#4x33 M2

Jargy part no.	Client part no.	Approved	SCALE	UNIT
CBL-PD302MBS-XmDA			1 : 1	mm
Drawing Name		Drawn	Date	REV.
USB 3.0 A to MicroB Cable M/M		<i>Kevin Hsu</i>	2015/08/25	1.0

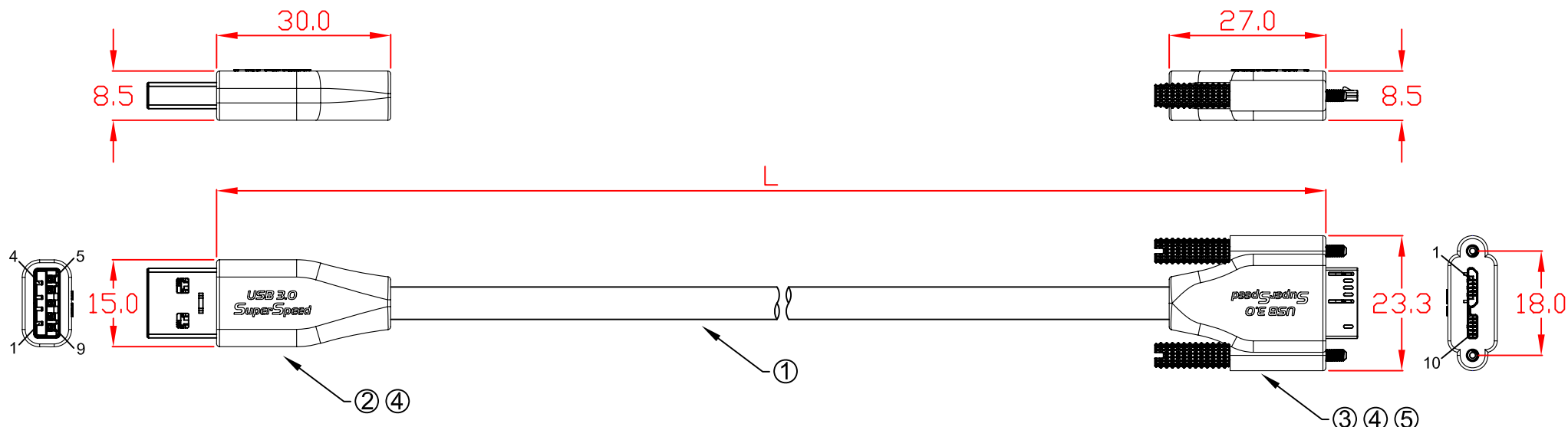

L:

- CBL-PD302MBSWB-4m 4000mm±30mm
- CBL-PD302MBSWB-5m 5000mm±30mm
- CBL-PD302MBSWB-6m 6000mm±30mm
- CBL-PD302MBSWB-7m 7000mm±30mm

No	MATERIALS LIST:
1.	CABLE:UL2725 (28AWG*1PR+D+AM)x2C+28AWG*1PR+24AWG*1C+AM+B OD:5.6mm PVC JACKET COLOR:BLACK
2.	CONNECTOR:USB 3.0 A/M, 9P, BLUE INSULATOR SOLDER TYPE, NICKEL PLATED SHELL
3.	CONNECTOR:USB 3.0 MicroB/M, 10P, BLACK INSULATOR SOLDER TYPE, NICKEL PLATED SHELL
4.	PVC MOLDED HOUSING, BLACK COLOR
5.	SCREW:#4x33 M2

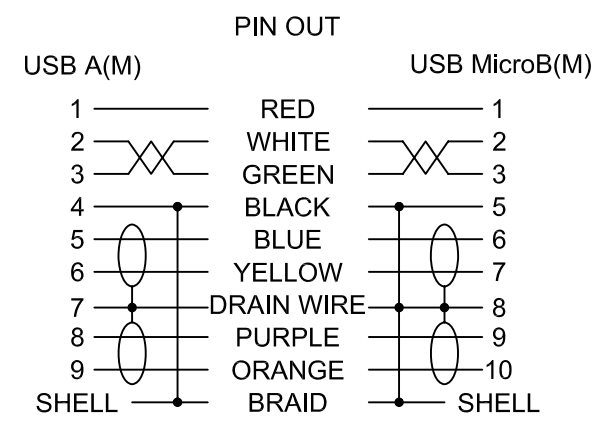

Jargy part no.	Client part no.	Approved	SCALE	UNIT
CBL-PD302MBSWB-Xm			1 : 1	mm
Drawing Name		Drawn	Date	REV.
USB 3.0 A to MicroB Cable M/M		<i>Kevin Hsu</i>	2015/08/25	1.0

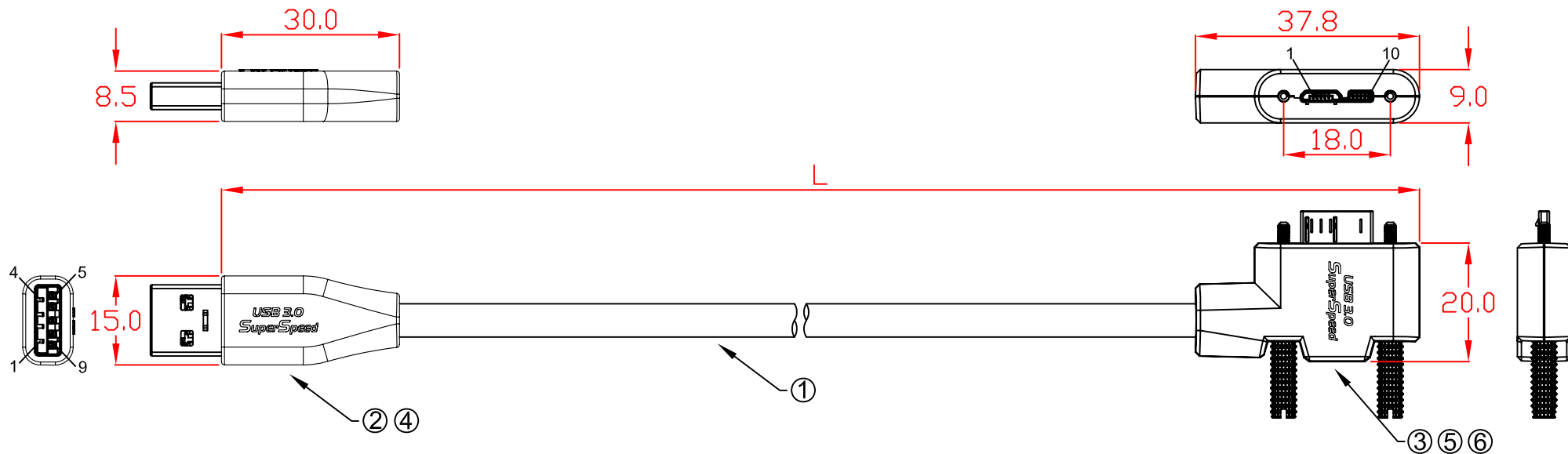

- L:
- CBL-PD302MBSWB-4mLA 4000mm±30mm
 - CBL-PD302MBSWB-5mLA 5000mm±30mm
 - CBL-PD302MBSWB-6mLA 6000mm±30mm
 - CBL-PD302MBSWB-7mLA 7000mm±30mm

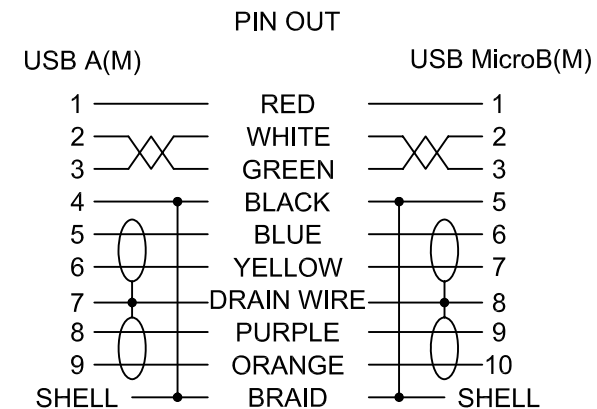

No	MATERIALS LIST:
1.	CABLE:UL2725 (28AWG*1PR+D+AM)x2C+28AWG*1PR+24AWG*1C+AM+B OD:5.6mm PVC JACKET COLOR:BLACK
2.	CONNECTOR:USB 3.0 A/M, 9P, BLUE INSULATOR SOLDER TYPE, NICKEL PLATED SHELL
3.	CONNECTOR:USB 3.0 MicroB/M, 10P, BLACK INSULATOR SOLDER TYPE, NICKEL PLATED SHELL
4.	PVC MOLDED HOUSING, BLACK COLOR
5.	ABS ASSEMBLY HOUSING, BLACK COLOR
6.	SCREW:#4x33 M2

Jargy part no.	Client part no.	Approved	SCALE	UNIT
CBL-PD302MBSWB-XmLA			1 : 1	mm
Drawing Name		Drawn	Date	REV.
USB 3.0 A to MicroB Cable M/M		<i>Kevin Hsu</i>	2015/08/25	1.0

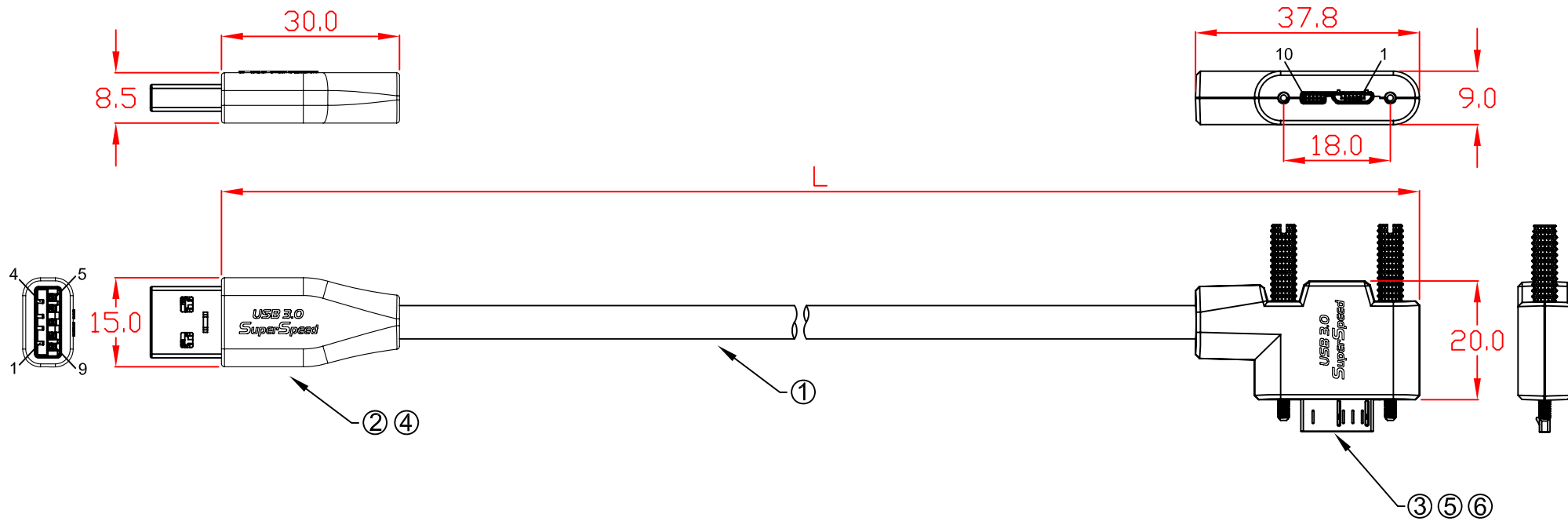

- L:
- CBL-PD302MBSWB-4mRA 4000mm±30mm
 - CBL-PD302MBSWB-5mRA 5000mm±30mm
 - CBL-PD302MBSWB-6mRA 6000mm±30mm
 - CBL-PD302MBSWB-7mRA 7000mm±30mm

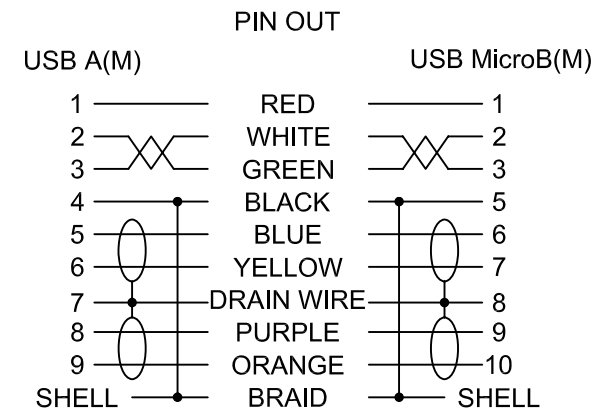

No	MATERIALS LIST:
1.	CABLE:UL2725 (28AWG*1PR+D+AM)x2C+28AWG*1PR+24AWG*1C+AM+B OD:5.6mm PVC JACKET COLOR:BLACK
2.	CONNECTOR:USB 3.0 A/M, 9P, BLUE INSULATOR SOLDER TYPE, NICKEL PLATED SHELL
3.	CONNECTOR:USB 3.0 MicroB/M, 10P, BLACK INSULATOR SOLDER TYPE, NICKEL PLATED SHELL
4.	PVC MOLDED HOUSING, BLACK COLOR
5.	ABS ASSEMBLY HOUSING, BLACK COLOR
6.	SCREW:#4x33 M2

Jargy part no.	Client part no.	Approved	SCALE	UNIT
CBL-PD302MBSWB-XmRA			1 : 1	mm
Drawing Name		Drawn	Date	REV.
USB 3.0 A to MicroB Cable M/M		<i>Kevin Hsu</i>	2015/08/25	1.0

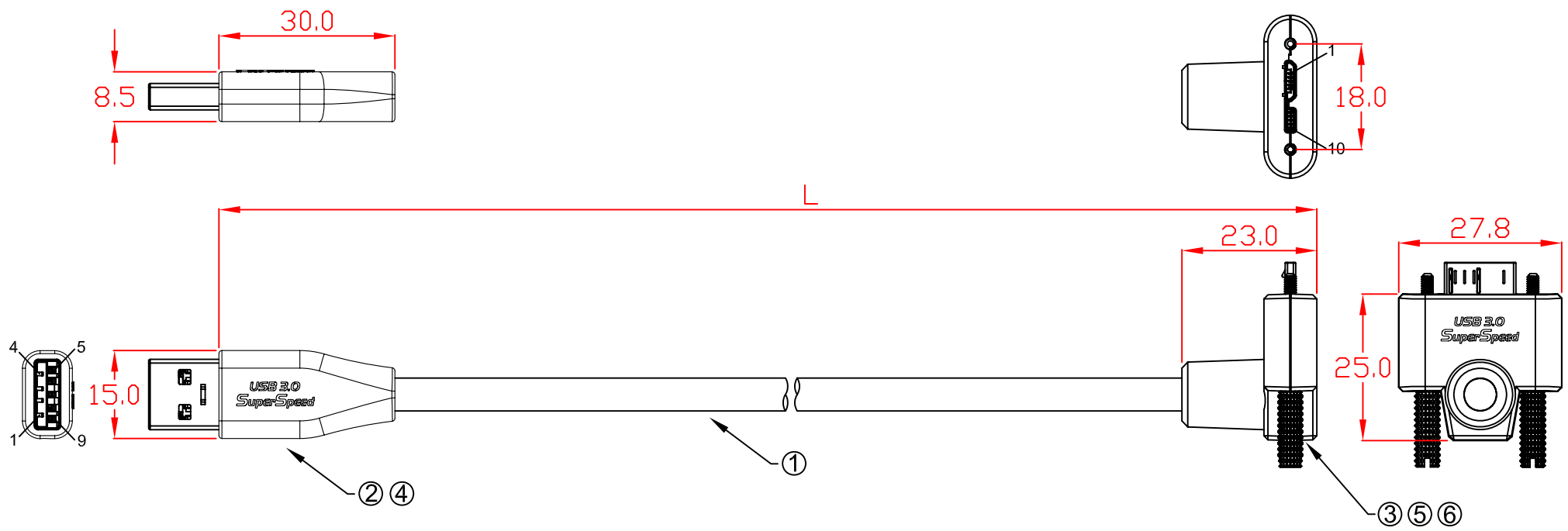

- L:
- CBL-PD302MBSWB-4mUA 4000mm±30mm
 - CBL-PD302MBSWB-5mUA 5000mm±30mm
 - CBL-PD302MBSWB-6mUA 6000mm±30mm
 - CBL-PD302MBSWB-7mUA 7000mm±30mm

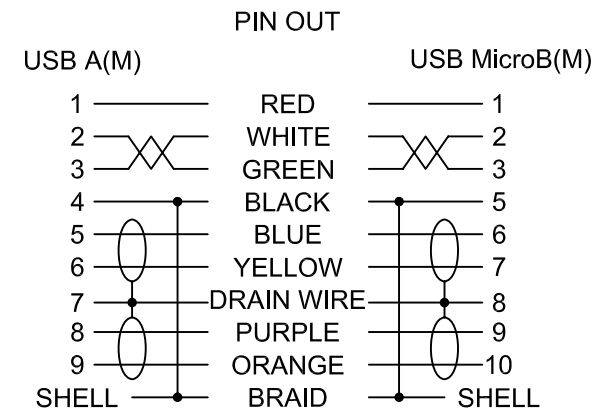

No	MATERIALS LIST:
1.	CABLE:UL2725 (28AWG*1PR+D+AM)x2C+28AWG*1PR+24AWG*1C+AM+B OD:5.6mm PVC JACKET COLOR:BLACK
2.	CONNECTOR:USB 3.0 A/M, 9P, BLUE INSULATOR SOLDER TYPE, NICKEL PLATED SHELL
3.	CONNECTOR:USB 3.0 MicroB/M, 10P, BLACK INSULATOR SOLDER TYPE, NICKEL PLATED SHELL
4.	PVC MOLDED HOUSING, BLACK COLOR
5.	ABS ASSEMBLY HOUSING, BLACK COLOR
6.	SCREW:#4x33 M2

Jargy part no.	Client part no.	Approved	SCALE	UNIT
CBL-PD302MBSWB-XmUA			1 : 1	mm
Drawing Name		Drawn	Date	REV.
USB 3.0 A to MicroB Cable M/M		<i>Kevin Hsu</i>	2015/08/25	1.0

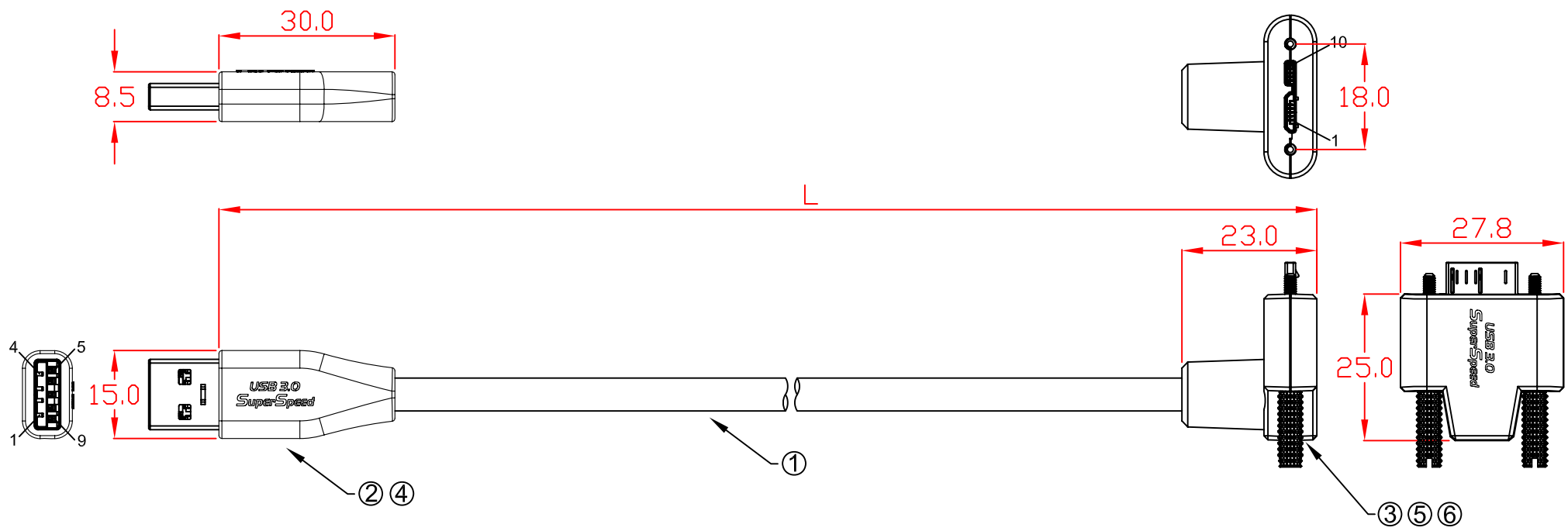

- L:
- CBL-PD302MBSWB-4mDA 4000mm±30mm
 - CBL-PD302MBSWB-5mDA 5000mm±30mm
 - CBL-PD302MBSWB-6mDA 6000mm±30mm
 - CBL-PD302MBSWB-7mDA 7000mm±30mm

PIN OUT

USB A(M)

USB MicroB(M)

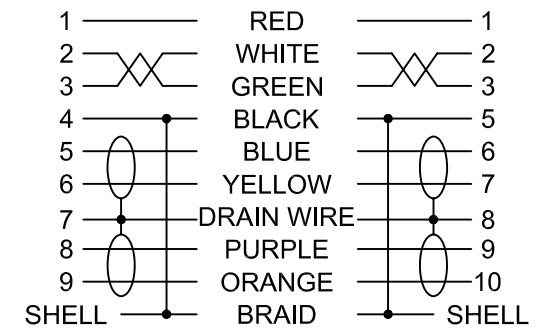

No	MATERIALS LIST:
1.	CABLE:UL2725 (28AWG*1PR+D+AM)x2C+28AWG*1PR+24AWG*1C+AM+B OD:5.6mm PVC JACKET COLOR:BLACK
2.	CONNECTOR:USB 3.0 A/M, 9P, BLUE INSULATOR SOLDER TYPE, NICKEL PLATED SHELL
3.	CONNECTOR:USB 3.0 MicroB/M, 10P, BLACK INSULATOR SOLDER TYPE, NICKEL PLATED SHELL
4.	PVC MOLDED HOUSING, BLACK COLOR
5.	ABS ASSEMBLY HOUSING, BLACK COLOR
6.	SCREW:#4x33 M2

Jargy part no.	Client part no.	Approved	SCALE	UNIT
CBL-PD302MBSWB-XmDA			1 : 1	mm
Drawing Name		Drawn	Date	REV.
USB 3.0 A to MicroB Cable M/M		<i>Kevin Hsu</i>	2015/08/25	1.0

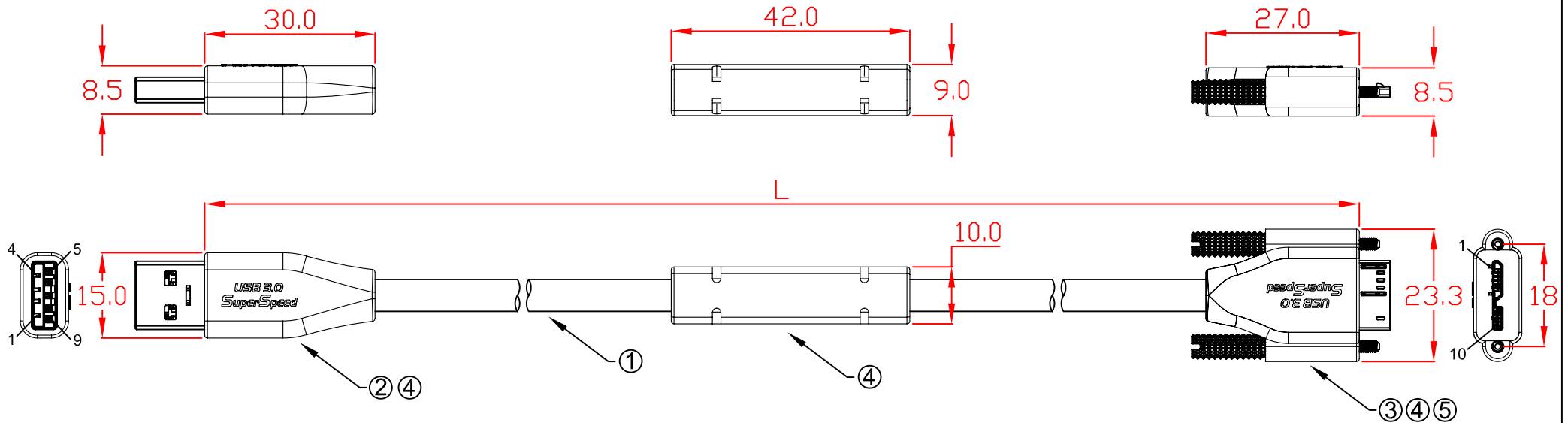

L:
 CBL-ED302MBCS-5m 5000mm±30mm
 CBL-ED302MBCS-7m 7000mm±30mm
 CBL-ED302MBCS-10m 10000mm±30mm

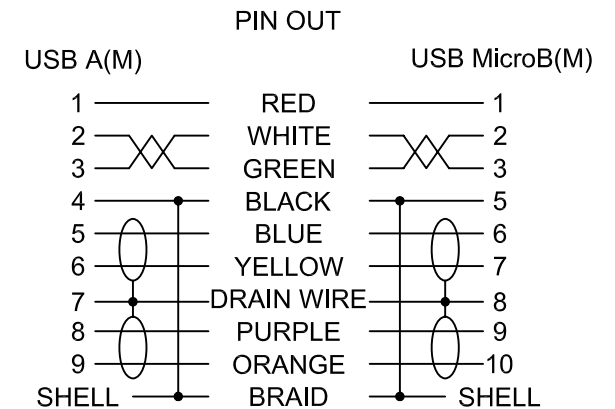

No	MATERIALS LIST:
1.	CABLE:UL2725 (28AWG*1PR+D+AM)x2C+28AWG*1PR+24AWG*1C+AM+B OD:5.6mm PVC JACKET COLOR:BLACK
2.	CONNECTOR:USB 3.0 A/M, 9P, BLUE INSULATOR SOLDER TYPE, PIN 30u" NICKEL PLATED SHELL
3.	CONNECTOR:USB 3.0 MicroB/M, 10P, BLACK INSULATOR SOLDER TYPE, PIN 30u" NICKEL PLATED SHELL
4.	PVC MOLDED HOUSING, BLACK COLOR
5.	SCREW:#4x33 M2

Jargy part no.	Client part no.	Approved	SCALE	UNIT
CBL-ED302MBCS-Xm			1 : 1	mm
Drawing Name		Drawn	Date	REV.
USB 3.0 A to MicroB Cable M/M		<i>Kevin Hsu</i>	2015/08/13	1.0

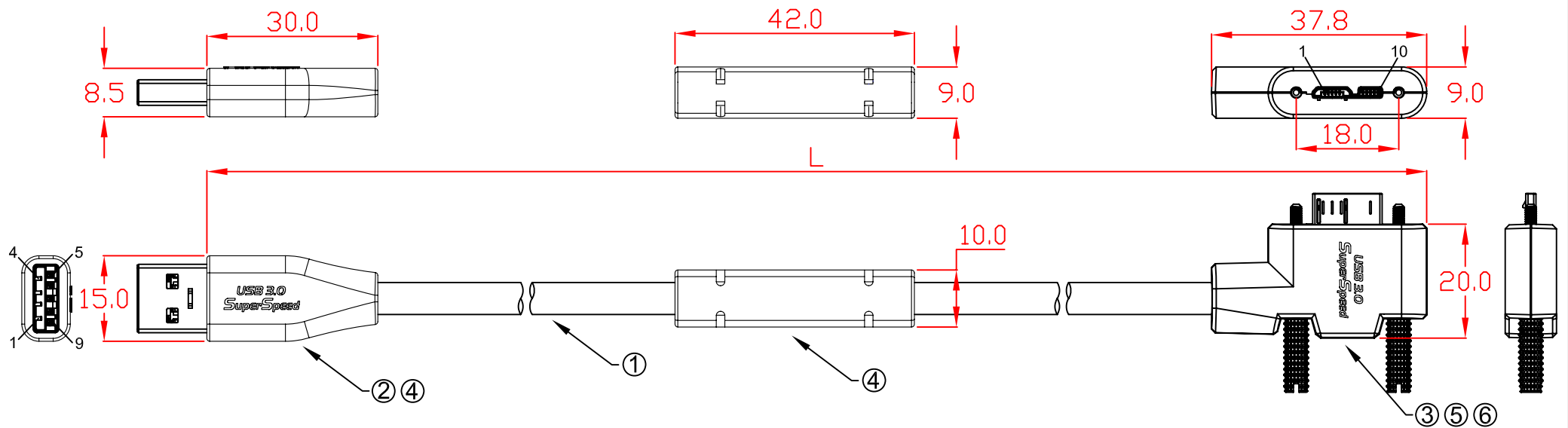

L:
 CBL-ED302MBCS-5mLA 5000mm±30mm
 CBL-ED302MBCS-7mLA 7000mm±30mm
 CBL-ED302MBCS-10mLA 10000mm±30mm

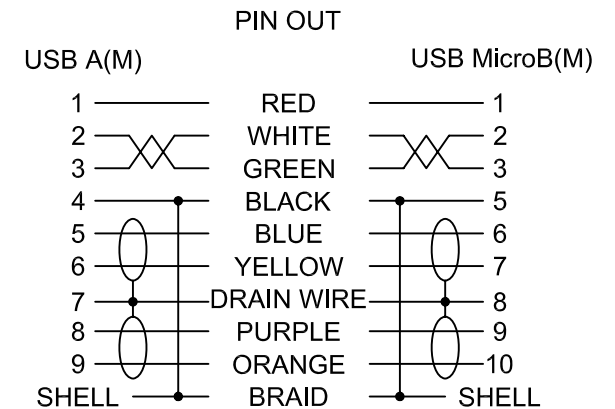

No	MATERIALS LIST:
1.	CABLE:UL2725 (28AWG*1PR+D+AM)x2C+28AWG*1PR+24AWG*1C+AM+B OD:5.6mm PVC JACKET COLOR:BLACK
2.	CONNECTOR:USB 3.0 A/M, 9P, BLUE INSULATOR SOLDER TYPE, NICKEL PLATED SHELL
3.	CONNECTOR:USB 3.0 MicroB/M, 10P, BLACK INSULATOR SOLDER TYPE, NICKEL PLATED SHELL
4.	PVC MOLDED HOUSING, BLACK COLOR
5.	ABS ASSEMBLY HOUSING, BLACK COLOR
6.	SCREW:#4x33 M2

Jargy part no.	Client part no.	Approved	SCALE	UNIT
CBL-ED302MBCS-XmLA			1 : 1	mm
Drawing Name		Drawn	Date	REV.
USB 3.0 A to MicroB Cable M/M		<i>Kevin Hsu</i>	2015/08/20	1.0

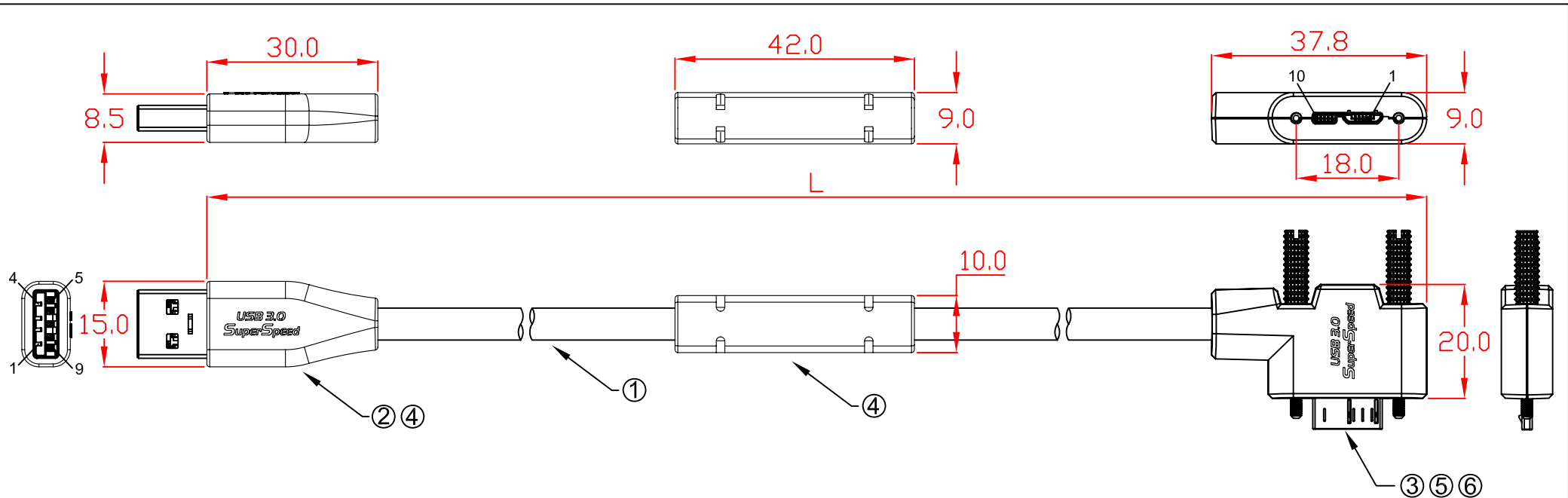

L:
 CBL-ED302MBCS-5mRA 5000mm±30mm
 CBL-ED302MBCS-7mRA 7000mm±30mm
 CBL-ED302MBCS-10mRA 10000mm±30mm

No	MATERIALS LIST:
1.	CABLE:UL2725 (28AWG*1PR+D+AM)x2C+28AWG*1PR+24AWG*1C+AM+B OD:5.6mm PVC JACKET COLOR:BLACK
2.	CONNECTOR:USB 3.0 A/M, 9P, BLUE INSULATOR SOLDER TYPE, NICKEL PLATED SHELL
3.	CONNECTOR:USB 3.0 MicroB/M, 10P, BLACK INSULATOR SOLDER TYPE, NICKEL PLATED SHELL
4.	PVC MOLDED HOUSING, BLACK COLOR
5.	ABS ASSEMBLY HOUSING, BLACK COLOR
6.	SCREW:#4x33 M2

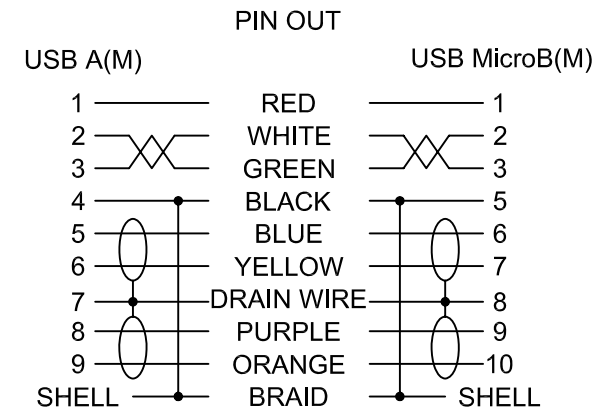

Jargy part no.	Client part no.	Approved	SCALE	UNIT
CBL-ED302MBCS-XmRA			1 : 1	mm
Drawing Name		Drawn	Date	REV.
USB 3.0 A to MicroB Cable M/M		<i>Kevin Hsu</i>	2015/08/20	1.0

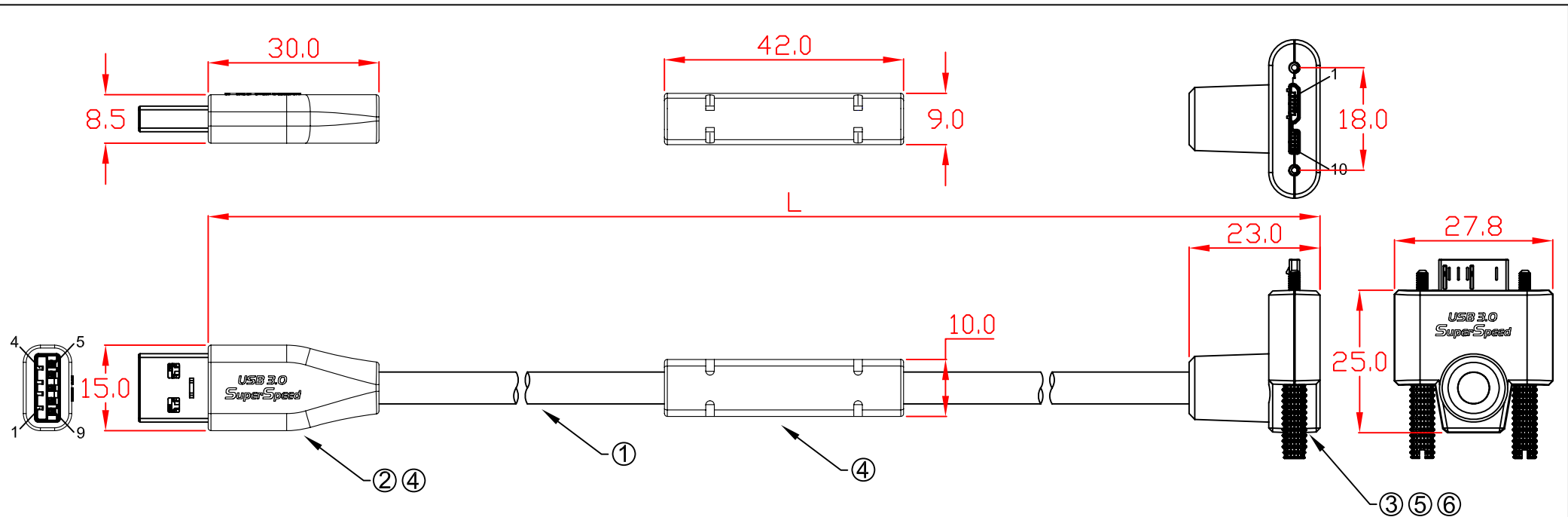

L:
 CBL-ED302MBCS-5mUA 5000mm±30mm
 CBL-ED302MBCS-7mUA 7000mm±30mm
 CBL-ED302MBCS-10mUA 10000mm±30mm

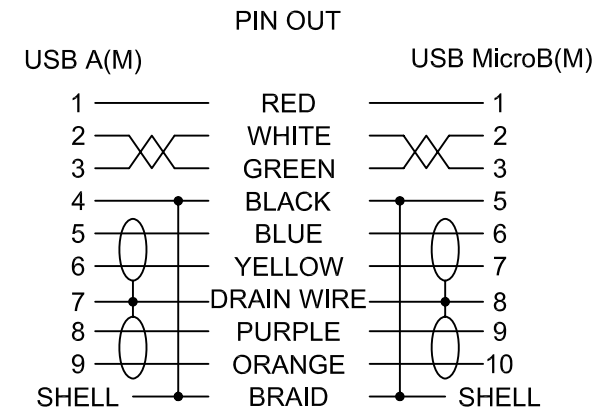

No	MATERIALS LIST:
1.	CABLE:UL2725 (28AWG*1PR+D+AM)x2C+28AWG*1PR+24AWG*1C+AM+B OD:5.6mm PVC JACKET COLOR:BLACK
2.	CONNECTOR:USB 3.0 A/M, 9P, BLUE INSULATOR SOLDER TYPE, NICKEL PLATED SHELL
3.	CONNECTOR:USB 3.0 MicroB/M, 10P, BLACK INSULATOR SOLDER TYPE, NICKEL PLATED SHELL
4.	PVC MOLDED HOUSING, BLACK COLOR
5.	ABS ASSEMBLY HOUSING, BLACK COLOR
6.	SCREW:#4x33 M2

Jargy part no.	Client part no.	Approved	SCALE	UNIT
CBL-ED302MBCS-XmUA			1 : 1	mm
Drawing Name		Drawn	Date	REV.
USB 3.0 A to MicroB Cable M/M		<i>Kevin Hsu</i>	2015/0820	1.0

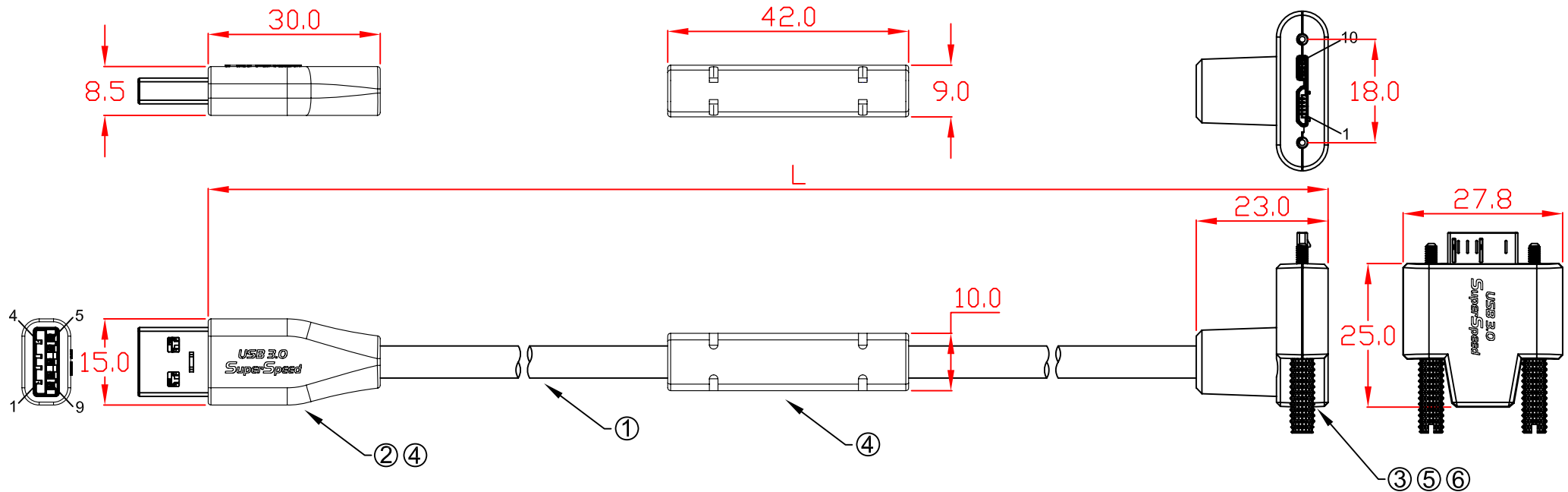

L:
 CBL-ED302MBCS-5mDA 5000mm±30mm
 CBL-ED302MBCS-7mDA 7000mm±30mm
 CBL-ED302MBCS-10mDA 10000mm±30mm

No	MATERIALS LIST:
1.	CABLE:UL2725 (28AWG*1PR+D+AM)x2C+28AWG*1PR+24AWG*1C+AM+B OD:5.6mm PVC JACKET COLOR:BLACK
2.	CONNECTOR:USB 3.0 A/M, 9P, BLUE INSULATOR SOLDER TYPE, NICKEL PLATED SHELL
3.	CONNECTOR:USB 3.0 MicroB/M, 10P, BLACK INSULATOR SOLDER TYPE, NICKEL PLATED SHELL
4.	PVC MOLDED HOUSING, BLACK COLOR
5.	ABS ASSEMBLY HOUSING, BLACK COLOR
6.	SCREW:#4x33 M2

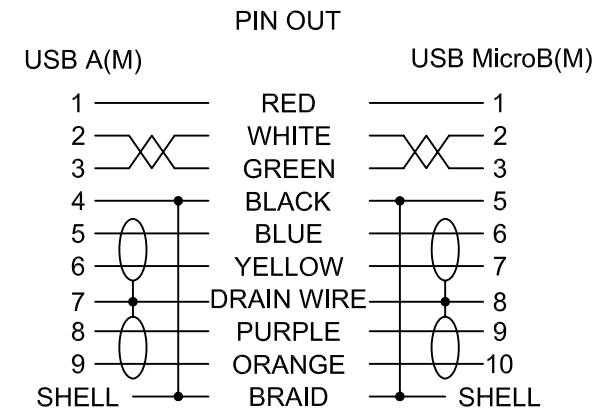

Jargy part no.	Client part no.	Approved	SCALE	UNIT
CBL-ED302MBCS-XmDA			1 : 1	mm
Drawing Name		Drawn	Date	REV.
USB 3.0 A to MicroB Cable M/M		<i>Kevin Hsu</i>	2015/08/21	1.0

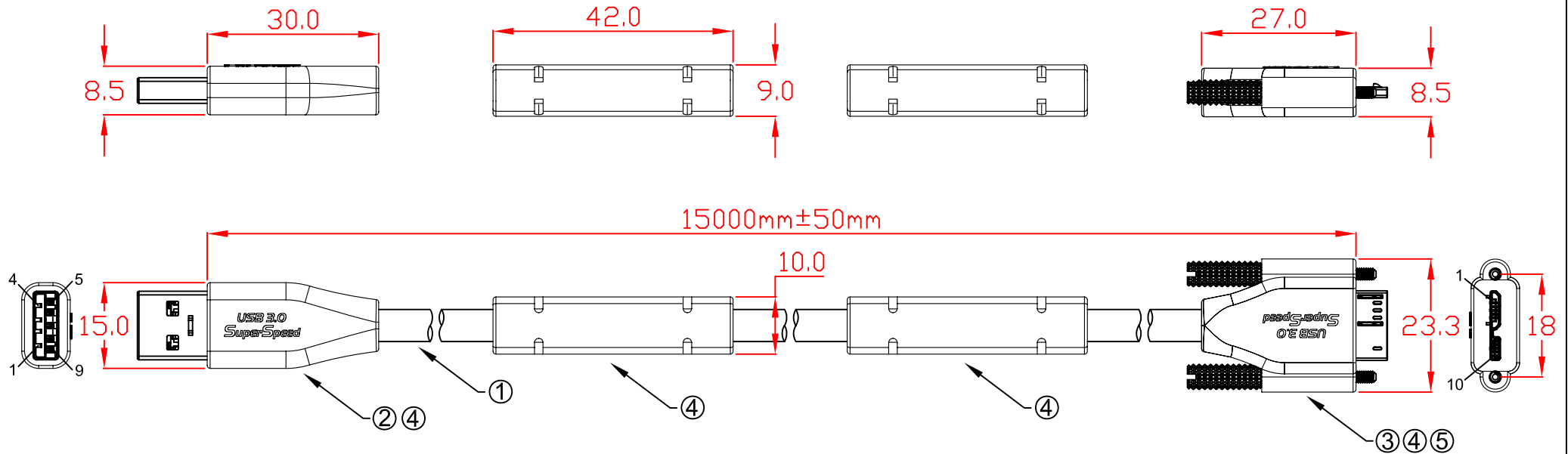

CBL-ED302MBCSWB-15m 15000mm±50mm

No MATERIALS LIST:

1.	CABLE:UL2725 (28AWG*1PR+D+AM)x2C+28AWG*1PR+24AWG*1C+AM+B OD:5.6mm PVC JACKET COLOR:BLACK
2.	CONNECTOR:USB 3.0 A/M, 9P, BLUE INSULATOR SOLDER TYPE, NICKEL PLATED SHELL
3.	CONNECTOR:USB 3.0 MicroB/M, 10P, BLACK INSULATOR SOLDER TYPE, NICKEL PLATED SHELL
4.	PVC MOLDED HOUSING, BLACK COLOR
5.	SCREW:#4x33 M2

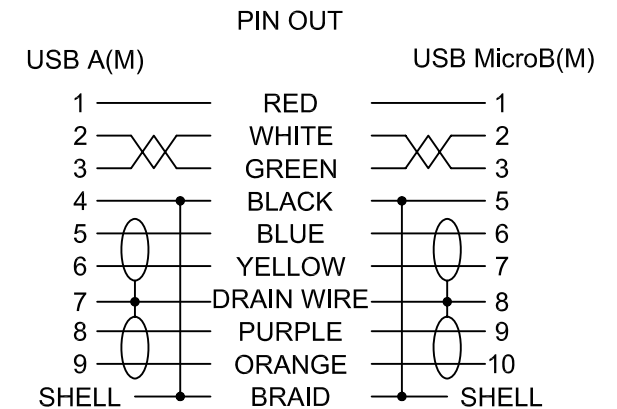

Jargy part no.	Client part no.	Approved	SCALE	UNIT
CBL-ED302MBCSWB-15m			1 : 1	mm
Drawing Name		Drawn	Date	REV.
15m USB 3.0 A to MicroB Cable M/M		<i>Kevin Hsu</i>	2015/08/13	1.0

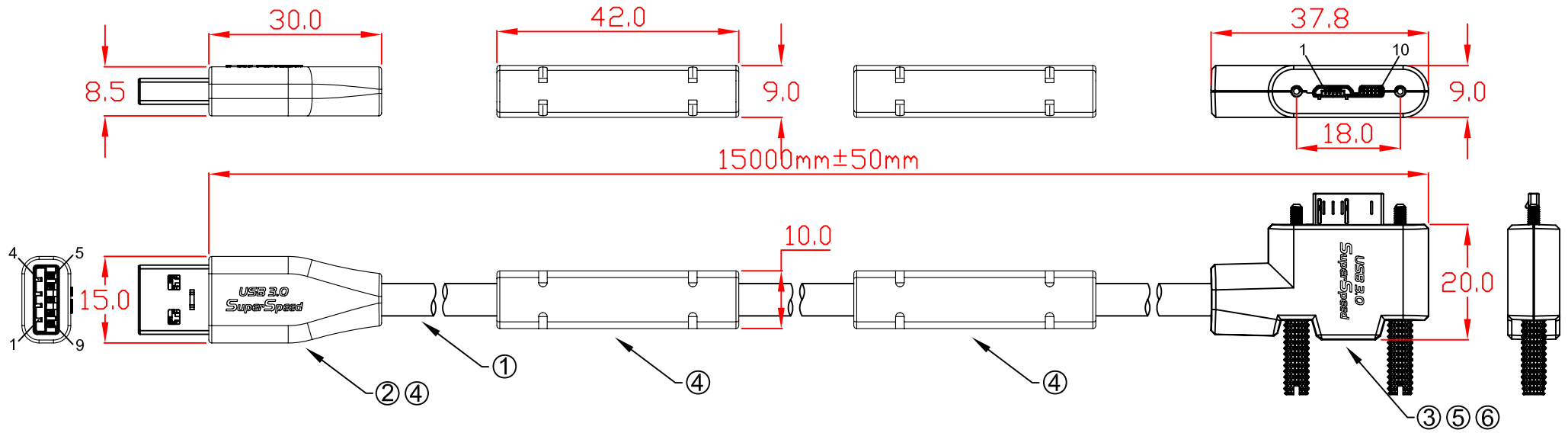

L:
CBL-ED302MBCSWB-15mLA 15000mm±50mm

No	MATERIALS LIST:
1.	CABLE:UL2725 (28AWG*1PR+D+AM)x2C+28AWG*1PR+24AWG*1C+AM+B OD:5.6mm PVC JACKET COLOR:BLACK
2.	CONNECTOR:USB 3.0 A/M, 9P, BLUE INSULATOR SOLDER TYPE, NICKEL PLATED SHELL
3.	CONNECTOR:USB 3.0 MicroB/M, 10P, BLACK INSULATOR SOLDER TYPE, NICKEL PLATED SHELL
4.	PVC MOLDED HOUSING, BLACK COLOR
5.	ABS ASSEMBLY HOUSING, BLACK COLOR
6.	SCREW:#4x33 M2

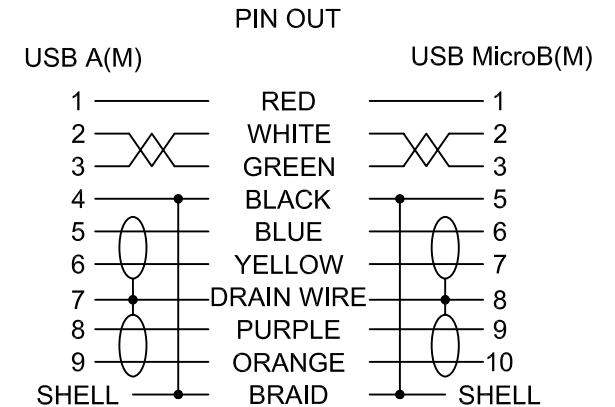

Jargy part no.	Client part no.	Approved	SCALE	UNIT
CBL-ED302MBCSWB-15mLA			1 : 1	mm
Drawing Name		Drawn	Date	REV.
15m USB 3.0 A to MicroB Cable M/M		<i>Kevin Hsu</i>	2015/08/21	1.0

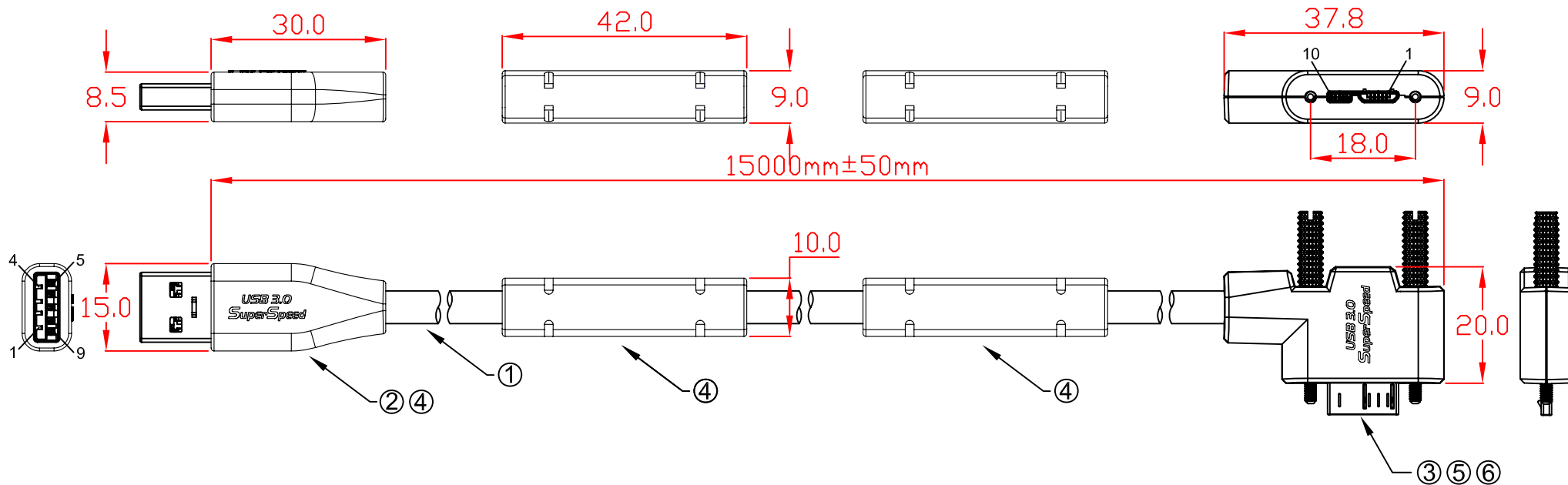

L:
CBL-ED302MBCSWB-15mRA 15000mm±50mm

No	MATERIALS LIST:
1.	CABLE:UL2725 (28AWG*1PR+D+AM)x2C+28AWG*1PR+24AWG*1C+AM+B OD:5.6mm PVC JACKET COLOR:BLACK
2.	CONNECTOR:USB 3.0 A/M, 9P, BLUE INSULATOR SOLDER TYPE, NICKEL PLATED SHELL
3.	CONNECTOR:USB 3.0 MicroB/M, 10P, BLACK INSULATOR SOLDER TYPE, NICKEL PLATED SHELL
4.	PVC MOLDED HOUSING, BLACK COLOR
5.	ABS ASSEMBLY HOUSING, BLACK COLOR
6.	SCREW:#4x33 M2

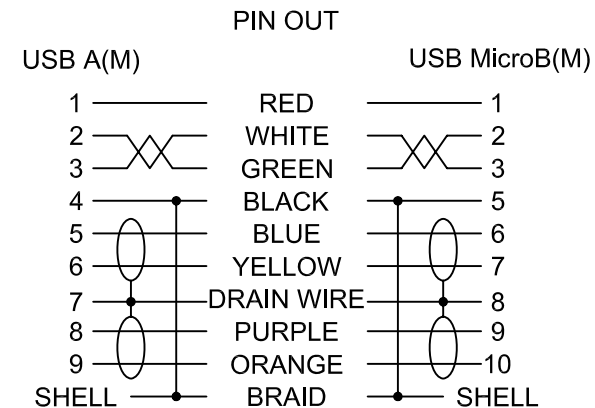

Jargy part no.	Client part no.	Approved	SCALE	UNIT
CBL-ED302MBCSWB-15mRA			1 : 1	mm
Drawing Name		Drawn	Date	REV.
15m USB 3.0 A to MicroB Cable M/M		<i>Kevin Hsu</i>	2015/08/21	1.0

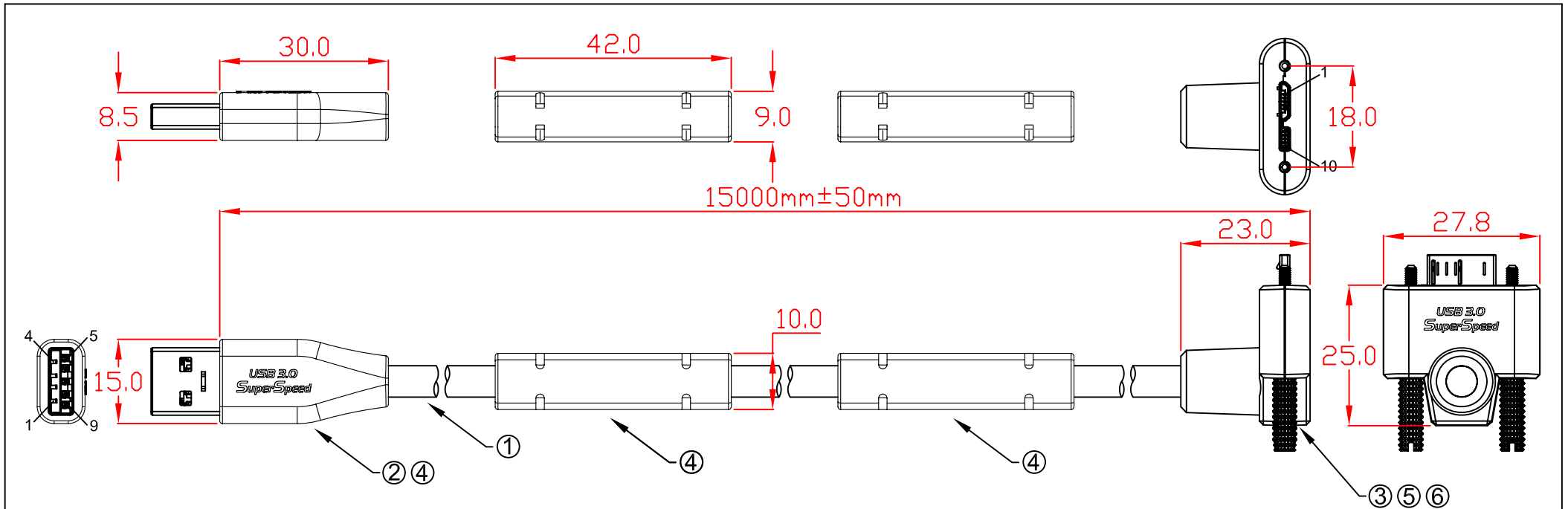

L:
CBL-ED302MBCSWB-15mUA 15000mm±50mm

No	MATERIALS LIST:
1.	CABLE:UL2725 (28AWG*1PR+D+AM)x2C+28AWG*1PR+24AWG*1C+AM+B OD:5.6mm PVC JACKET COLOR:BLACK
2.	CONNECTOR:USB 3.0 A/M, 9P, BLUE INSULATOR SOLDER TYPE, NICKEL PLATED SHELL
3.	CONNECTOR:USB 3.0 MicroB/M, 10P, BLACK INSULATOR SOLDER TYPE, NICKEL PLATED SHELL
4.	PVC MOLDED HOUSING, BLACK COLOR
5.	ABS ASSEMBLY HOUSING, BLACK COLOR
6.	SCREW:#4x33 M2

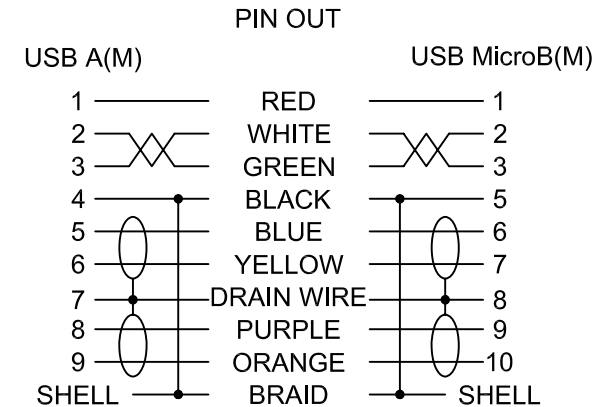

Jargy part no.	Client part no.	Approved	SCALE	UNIT
CBL-ED302MBCSWB-15mUA			1 : 1	mm
Drawing Name		Drawn	Date	REV.
15m USB 3.0 A to MicroB Cable M/M		<i>Kevin Hsu</i>	2015/08/21	1.0

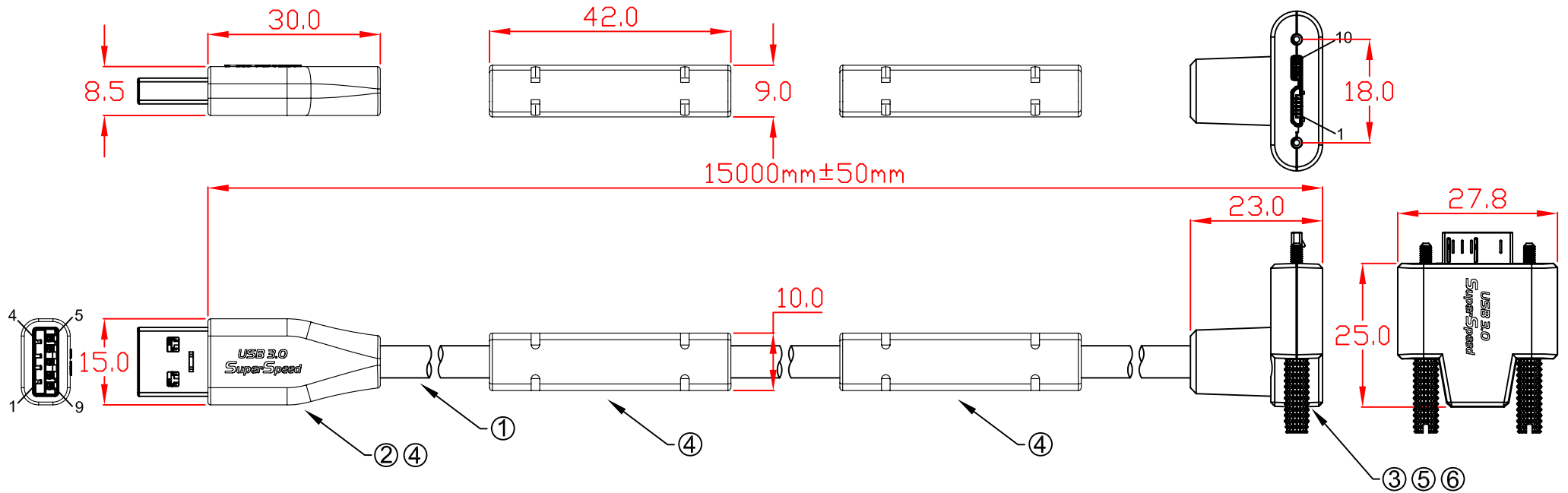

L:
CBL-ED302MBCSWB-15mDA 15000mm±50mm

No	MATERIALS LIST:
1.	CABLE:UL2725 (28AWG*1PR+D+AM)x2C+28AWG*1PR+24AWG*1C+AM+B OD:5.6mm PVC JACKET COLOR:BLACK
2.	CONNECTOR:USB 3.0 A/M, 9P, BLUE INSULATOR SOLDER TYPE, NICKEL PLATED SHELL
3.	CONNECTOR:USB 3.0 MicroB/M, 10P, BLACK INSULATOR SOLDER TYPE, NICKEL PLATED SHELL
4.	PVC MOLDED HOUSING, BLACK COLOR
5.	ABS ASSEMBLY HOUSING, BLACK COLOR
6.	SCREW:#4x33 M2

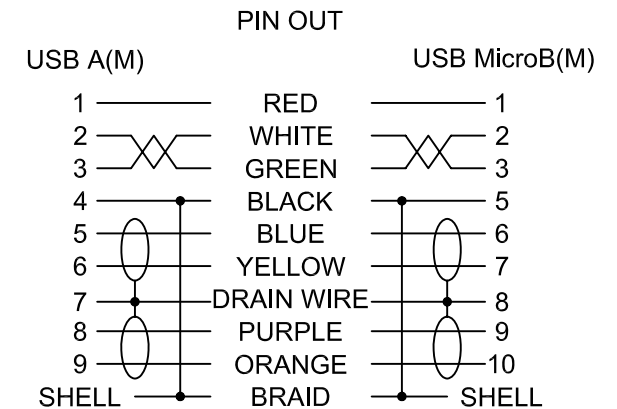

Jargy part no.	Client part no.	Approved	SCALE	UNIT
CBL-ED302MBCSWB-15mDA			1 : 1	mm
Drawing Name		Drawn	Date	REV.
15m USB 3.0 A to MicroB Cable M/M		<i>Kevin Hsu</i>	2015/08/21	1.0

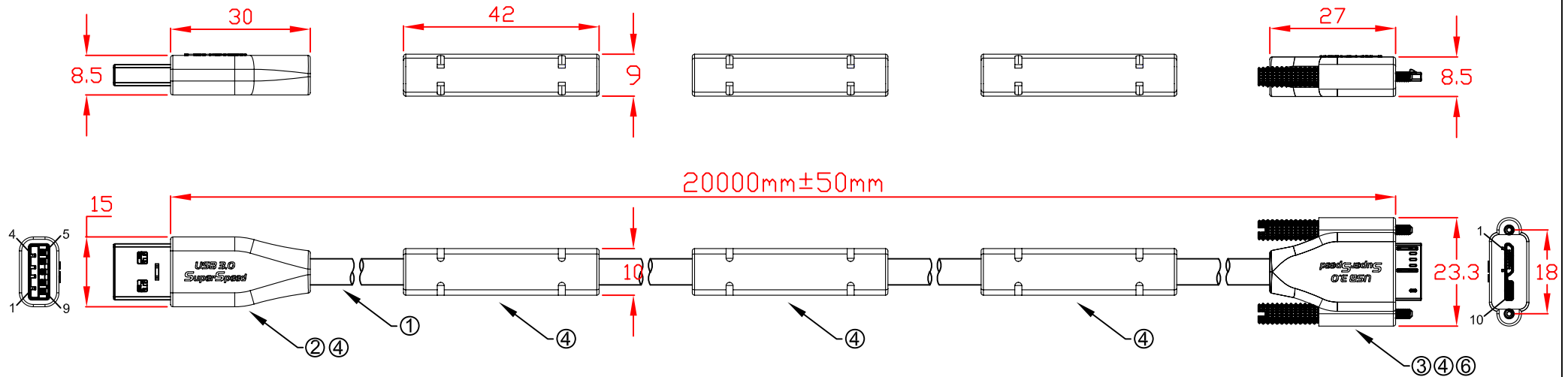

CBL-ED302MBCSWB-20m 20000mm±50mm

No	MATERIALS LIST:
1.	CABLE:UL2725 (28AWG*1PR+D+AM)x2C+28AWG*1PR+24AWG*1C+AM+B OD:5.6mm PVC JACKET COLOR:BLACK
2.	CONNECTOR:USB 3.0 A/M, 9P, BLUE INSULATOR SOLDER TYPE, NICKEL PLATED SHELL
3.	CONNECTOR:USB 3.0 MicroB/M, 10P, BLACK INSULATOR SOLDER TYPE, NICKEL PLATED SHELL
4.	PVC MOLDED HOUSING, BLACK COLOR
5.	SCREW:#4x33 M2

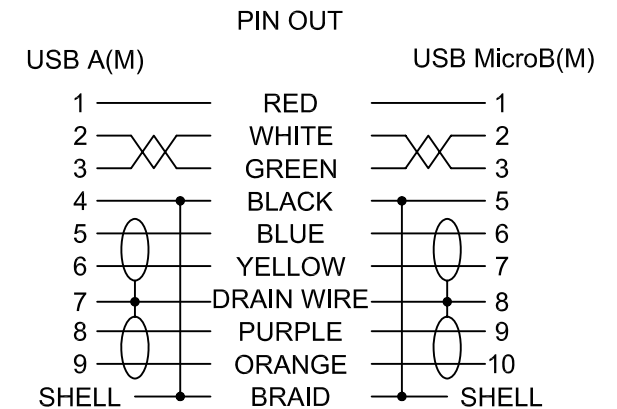

Jargy part no.	Client part no.	Approved	SCALE	UNIT
CBL-ED302MBCSWB-20m			1 : 2	mm
Drawing Name		Drawn	Date	REV.
20m USB 3.0 A to MicroB Cable M/M		<i>Kevin Hsu</i>	2015/08/13	1.0

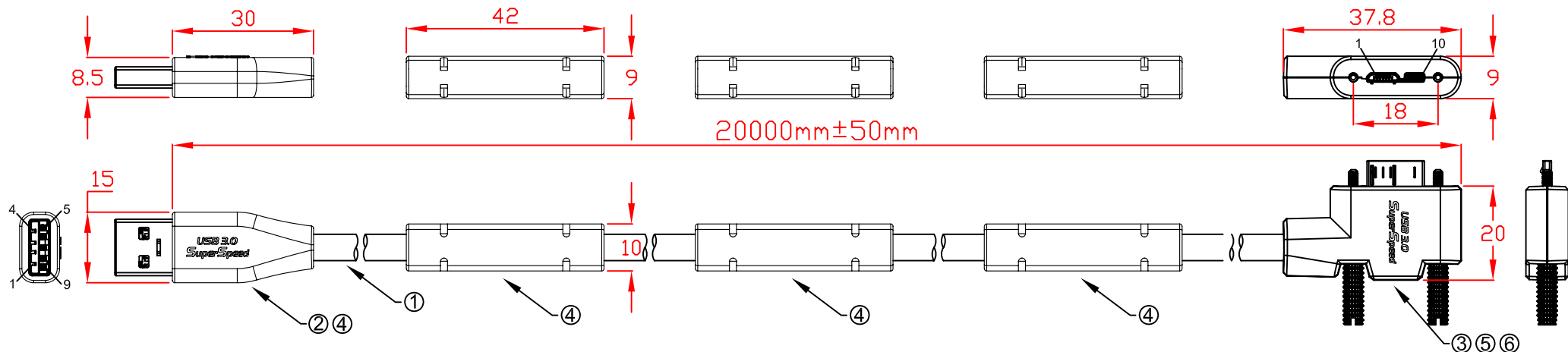

L:
CBL-ED302MBCSWB-20mLA 20000mm±50mm

No	MATERIALS LIST:
1.	CABLE:UL2725 (28AWG*1PR+D+AM)x2C+28AWG*1PR+24AWG*1C+AM+B OD:5.6mm PVC JACKET COLOR:BLACK
2.	CONNECTOR:USB 3.0 A/M, 9P, BLUE INSULATOR SOLDER TYPE, NICKEL PLATED SHELL
3.	CONNECTOR:USB 3.0 MicroB/M, 10P, BLACK INSULATOR SOLDER TYPE, NICKEL PLATED SHELL
4.	PVC MOLDED HOUSING, BLACK COLOR
5.	ABS ASSEMBLY HOUSING, BLACK COLOR
6.	SCREW:#4x33 M2

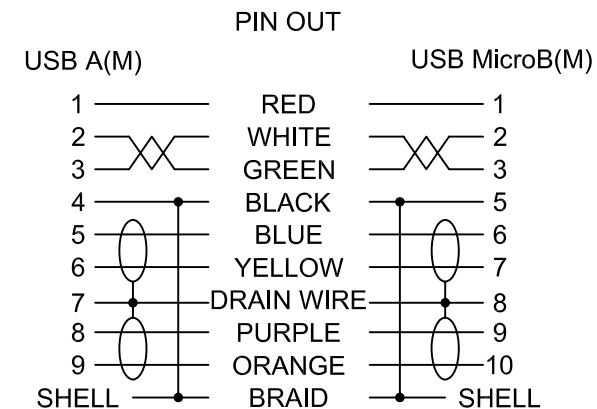

Jargy part no.	Client part no.	Approved	SCALE	UNIT
CBL-ED302MBCSWB-20mLA			1 : 2	mm
Drawing Name		Drawn	Date	REV.
20m USB 3.0 A to MicroB Cable M/M		<i>Kevin Hsu</i>	2015/08/21	1.0

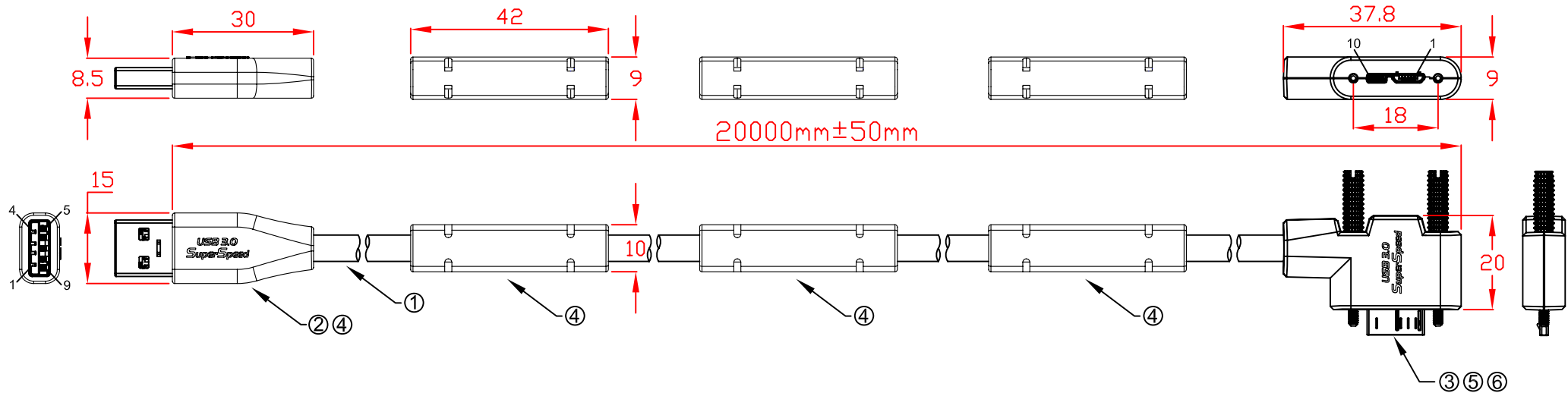

L:
CBL-ED302MBCSWB-20mRA 20000mm±50mm

No	MATERIALS LIST:
1.	CABLE:UL2725 (28AWG*1PR+D+AM)x2C+28AWG*1PR+24AWG*1C+AM+B OD:5.6mm PVC JACKET COLOR:BLACK
2.	CONNECTOR:USB 3.0 A/M, 9P, BLUE INSULATOR SOLDER TYPE, NICKEL PLATED SHELL
3.	CONNECTOR:USB 3.0 MicroB/M, 10P, BLACK INSULATOR SOLDER TYPE, NICKEL PLATED SHELL
4.	PVC MOLDED HOUSING, BLACK COLOR
5.	ABS ASSEMBLY HOUSING, BLACK COLOR
6.	SCREW:#4x33 M2

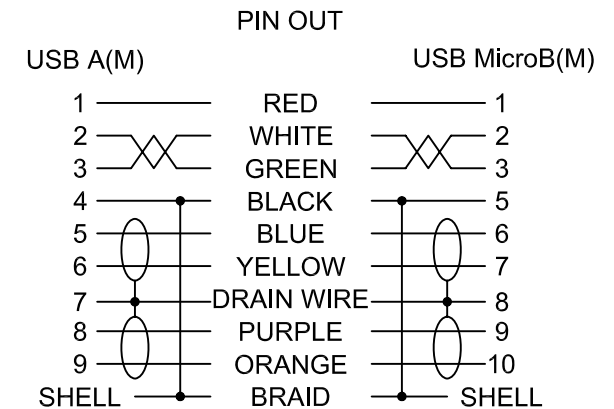

Jargy part no.	Client part no.	Approved	SCALE	UNIT
CBL-ED302MBCSWB-20mRA			1 : 2	mm
Drawing Name		Drawn	Date	REV.
20m USB 3.0 A to MicroB Cable M/M		<i>Kevin Hsu</i>	2015/08/21	1.0



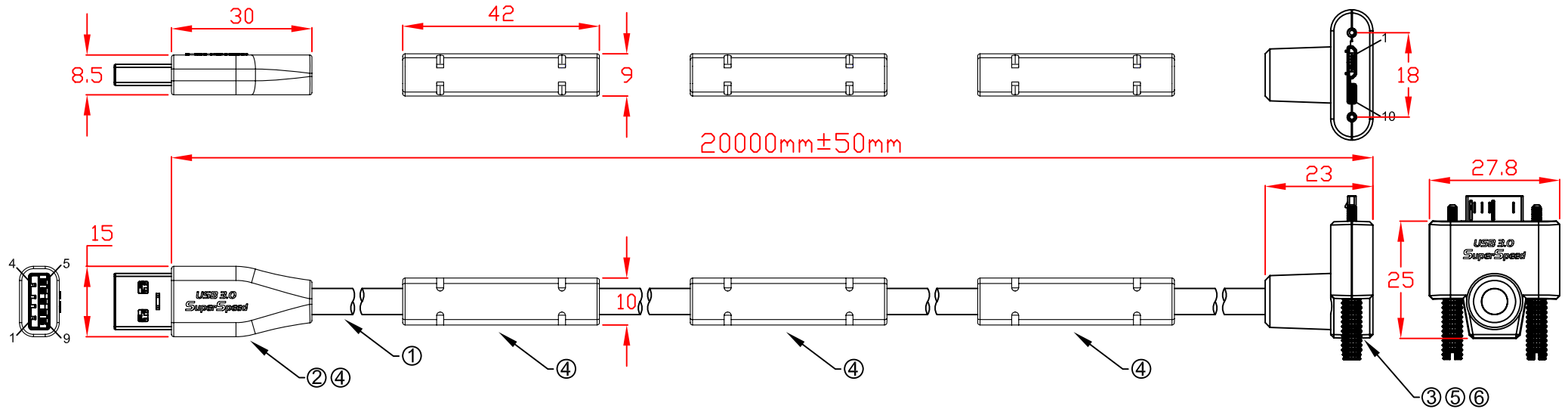

L:
CBL-ED302MBCSWB-20mUA 20000mm±50mm

No	MATERIALS LIST:
1.	CABLE:UL2725 (28AWG*1PR+D+AM)x2C+28AWG*1PR+24AWG*1C+AM+B OD:5.6mm PVC JACKET COLOR:BLACK
2.	CONNECTOR:USB 3.0 A/M, 9P, BLUE INSULATOR SOLDER TYPE, NICKEL PLATED SHELL
3.	CONNECTOR:USB 3.0 MicroB/M, 10P, BLACK INSULATOR SOLDER TYPE, NICKEL PLATED SHELL
4.	PVC MOLDED HOUSING, BLACK COLOR
5.	ABS ASSEMBLY HOUSING, BLACK COLOR
6.	SCREW:#4x33 M2

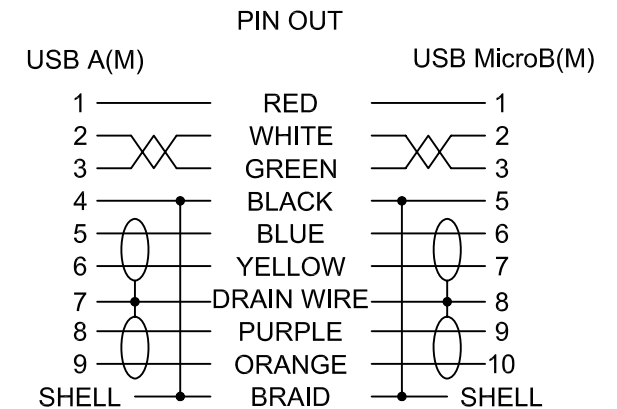

Jargy part no.	Client part no.	Approved	SCALE	UNIT
CBL-ED302MBCSWB-20mUA			1 : 2	mm
Drawing Name		Drawn	Date	REV.
20m USB 3.0 A to MicroB Cable M/M		<i>Kevin Hsu</i>	2015/08/21	1.0

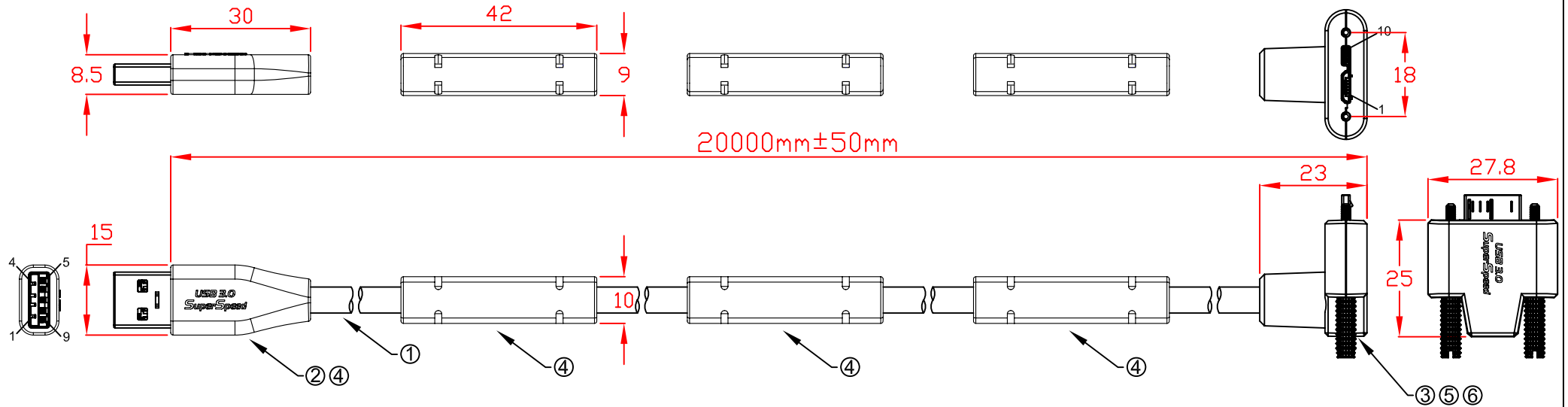

L:
CBL-ED302MBCSWB-20mDA 20000mm±50mm

No	MATERIALS LIST:
1.	CABLE:UL2725 (28AWG*1PR+D+AM)x2C+28AWG*1PR+24AWG*1C+AM+B OD:5.6mm PVC JACKET COLOR:BLACK
2.	CONNECTOR:USB 3.0 A/M, 9P, BLUE INSULATOR SOLDER TYPE, NICKEL PLATED SHELL
3.	CONNECTOR:USB 3.0 MicroB/M, 10P, BLACK INSULATOR SOLDER TYPE, NICKEL PLATED SHELL
4.	PVC MOLDED HOUSING, BLACK COLOR
5.	ABS ASSEMBLY HOUSING, BLACK COLOR
6.	SCREW:#4x33 M2

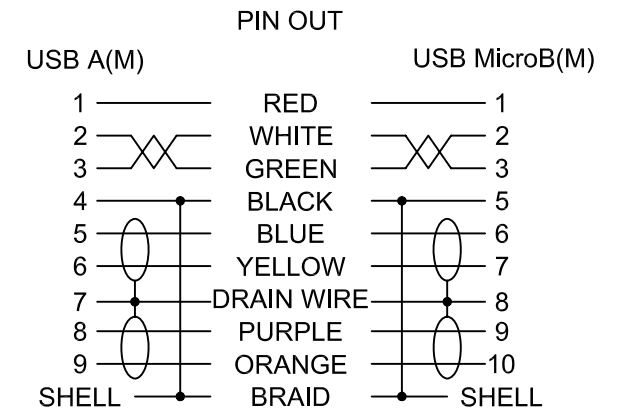

Jargy part no.	Client part no.	Approved	SCALE	UNIT
CBL-ED302MBCSWB-20mDA			1 : 2	mm
Drawing Name		Drawn	Date	REV.
20m USB 3.0 A to MicroB Cable M/M		<i>Kevin Hsu</i>	2015/08/21	1.0

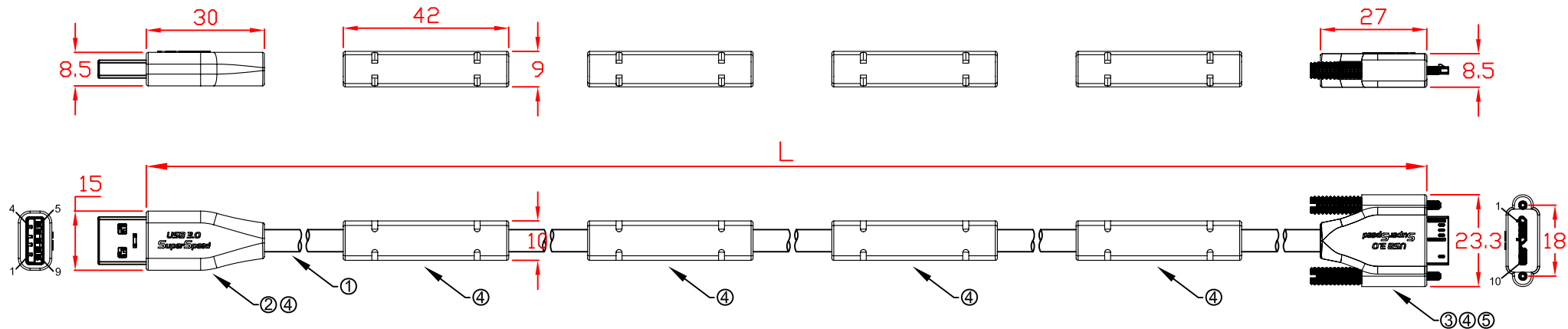

L:
 CBL-ED302MBCSWB-25m 25000mm±50mm
 CBL-ED302MBCSWB-30m 30000mm±50mm

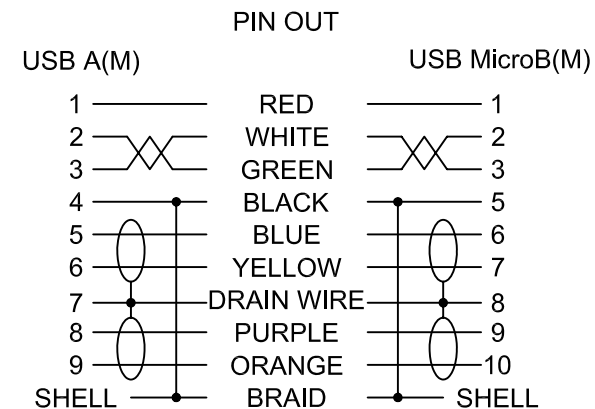

No	MATERIALS LIST:
1.	CABLE:UL2725 (28AWG*1PR+D+AM)x2C+28AWG*1PR+24AWG*1C+AM+B OD:5.6mm PVC JACKET COLOR:BLACK
2.	CONNECTOR:USB 3.0 A/M, 9P, BLUE INSULATOR SOLDER TYPE, NICKEL PLATED SHELL
3.	CONNECTOR:USB 3.0 MicroB/M, 10P, BLACK INSULATOR SOLDER TYPE, NICKEL PLATED SHELL
4.	PVC MOLDED HOUSING, BLACK COLOR
5.	SCREW:#4x33 M2

Jargy part no.	Client part no.	Approved	SCALE	UNIT
CBL-ED302MBCSWB-Xm			1 : 2	mm
Drawing Name		Drawn	Date	REV.
USB 3.0 A to MicroB Cable M/M		<i>Kevin Hsu</i>	2015/08/14	1.0

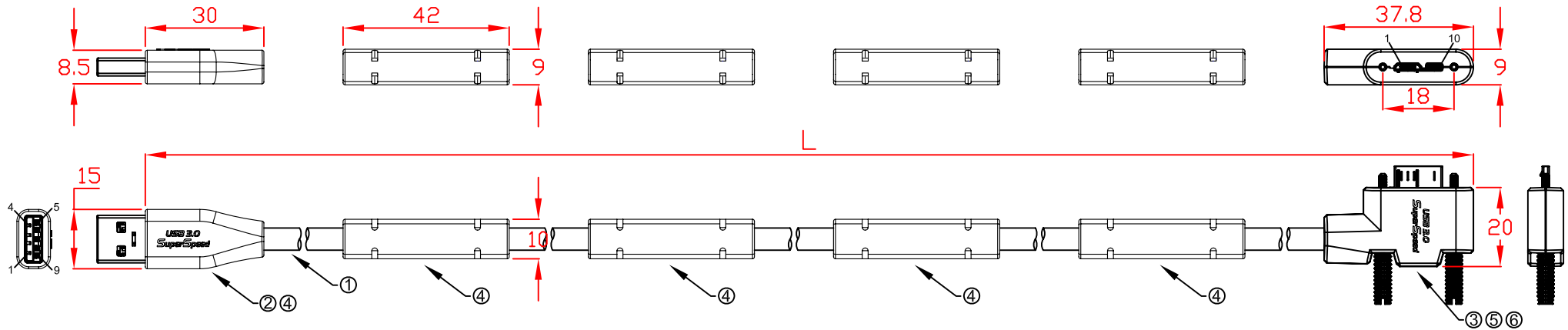

L:
 CBL-ED302MBCSWB-25mLA 25000mm±50mm
 CBL-ED302MBCSWB-30mLA 30000mm±50mm

No	MATERIALS LIST:
1.	CABLE:UL2725 (28AWG*1PR+D+AM)x2C+28AWG*1PR+24AWG*1C+AM+B OD:5.6mm PVC JACKET COLOR:BLACK
2.	CONNECTOR:USB 3.0 A/M, 9P, BLUE INSULATOR SOLDER TYPE, NICKEL PLATED SHELL
3.	CONNECTOR:USB 3.0 MicroB/M, 10P, BLACK INSULATOR SOLDER TYPE, NICKEL PLATED SHELL
4.	PVC MOLDED HOUSING, BLACK COLOR
5.	ABS ASSEMBLY HOUSING, BLACK COLOR
6.	SCREW:#4x33 M2

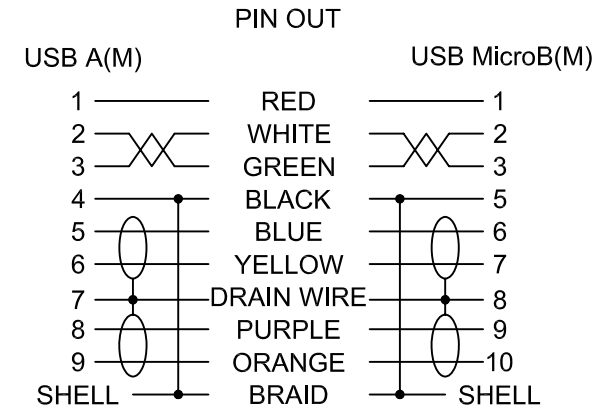

Jargy part no.	Client part no.	Approved	SCALE	UNIT
CBL-ED302MBCSWB-XmLA			1 : 2	mm
Drawing Name		Drawn	Date	REV.
USB 3.0 A to MicroB Cable M/M		<i>Kevin Hsu</i>	2015/08/21	1.0

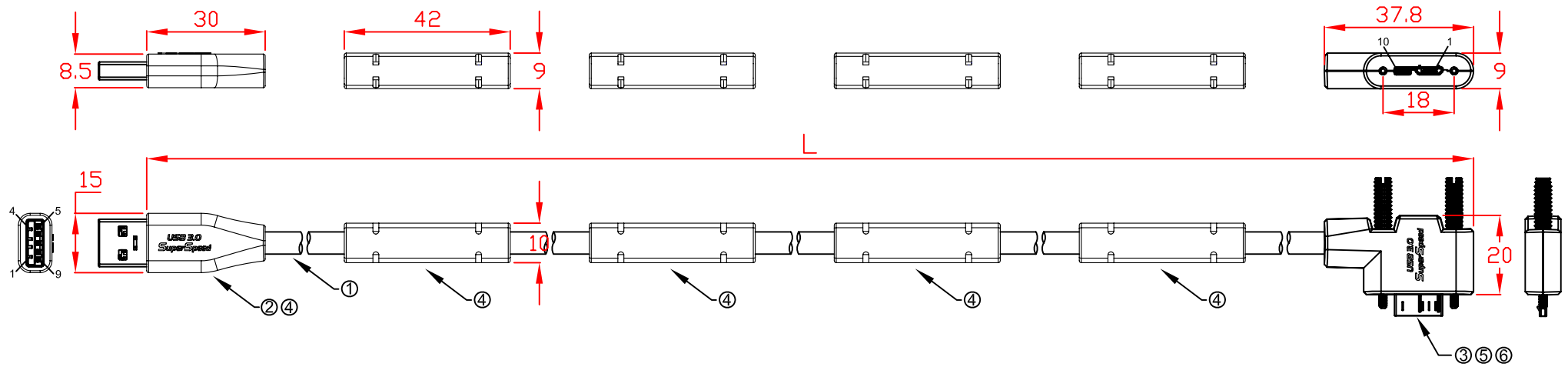

L:
 CBL-ED302MBCSWB-25mRA 25000mm±50mm
 CBL-ED302MBCSWB-30mRA 30000mm±50mm

No	MATERIALS LIST:
1.	CABLE:UL2725 (28AWG*1PR+D+AM)x2C+28AWG*1PR+24AWG*1C+AM+B OD:5.6mm PVC JACKET COLOR:BLACK
2.	CONNECTOR:USB 3.0 A/M, 9P, BLUE INSULATOR SOLDER TYPE, NICKEL PLATED SHELL
3.	CONNECTOR:USB 3.0 MicroB/M, 10P, BLACK INSULATOR SOLDER TYPE, NICKEL PLATED SHELL
4.	PVC MOLDED HOUSING, BLACK COLOR
5.	ABS ASSEMBLY HOUSING, BLACK COLOR
6.	SCREW:#4x33 M2

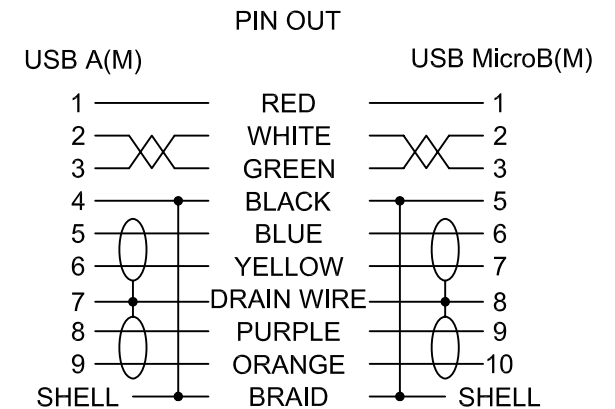

Jargy part no.	Client part no.	Approved	SCALE	UNIT
CBL-ED302MBCSWB-XmRA			1 : 2	mm
Drawing Name		Drawn	Date	REV.
USB 3.0 A to MicroB Cable M/M		<i>Kevin Hsu</i>	2015/08/21	1.0

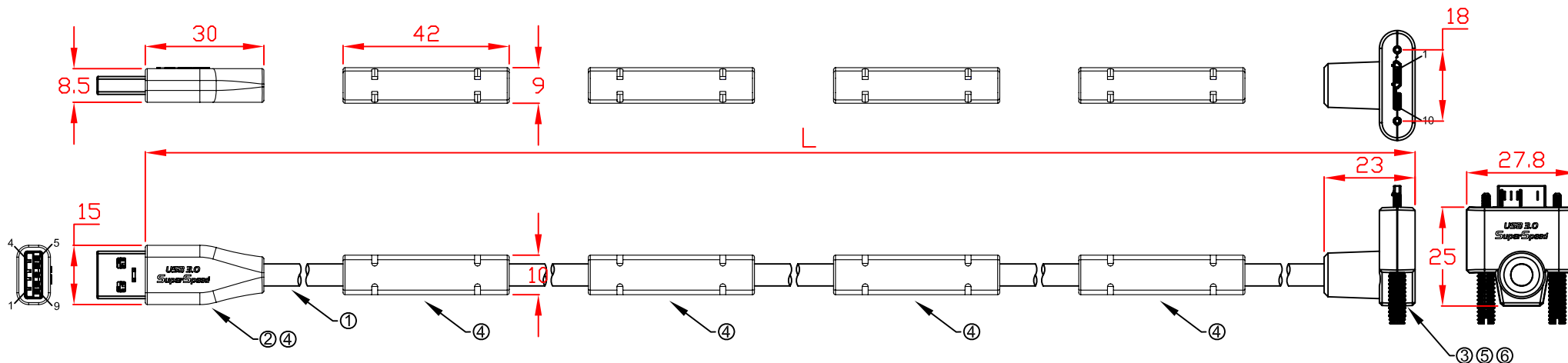

L:
 CBL-ED302MBCSWB-25mUA 25000mm±50mm
 CBL-ED302MBCSWB-30mUA 30000mm±50mm

No	MATERIALS LIST:
1.	CABLE:UL2725 (28AWG*1PR+D+AM)x2C+28AWG*1PR+24AWG*1C+AM+B OD:5.6mm PVC JACKET COLOR:BLACK
2.	CONNECTOR:USB 3.0 A/M, 9P, BLUE INSULATOR SOLDER TYPE, NICKEL PLATED SHELL
3.	CONNECTOR:USB 3.0 MicroB/M, 10P, BLACK INSULATOR SOLDER TYPE, NICKEL PLATED SHELL
4.	PVC MOLDED HOUSING, BLACK COLOR
5.	ABS ASSEMBLY HOUSING, BLACK COLOR
6.	SCREW:#4x33 M2

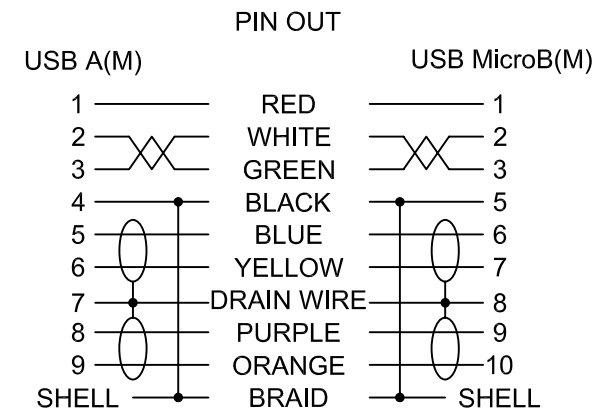

Jargy part no.	Client part no.	Approved	SCALE	UNIT
CBL-ED302MBCSWB-XmUA			1 : 2	mm
Drawing Name		Drawn	Date	REV.
USB 3.0 A to MicroB Cable M/M		<i>Kevin Hsu</i>	2015/08/21	1.0

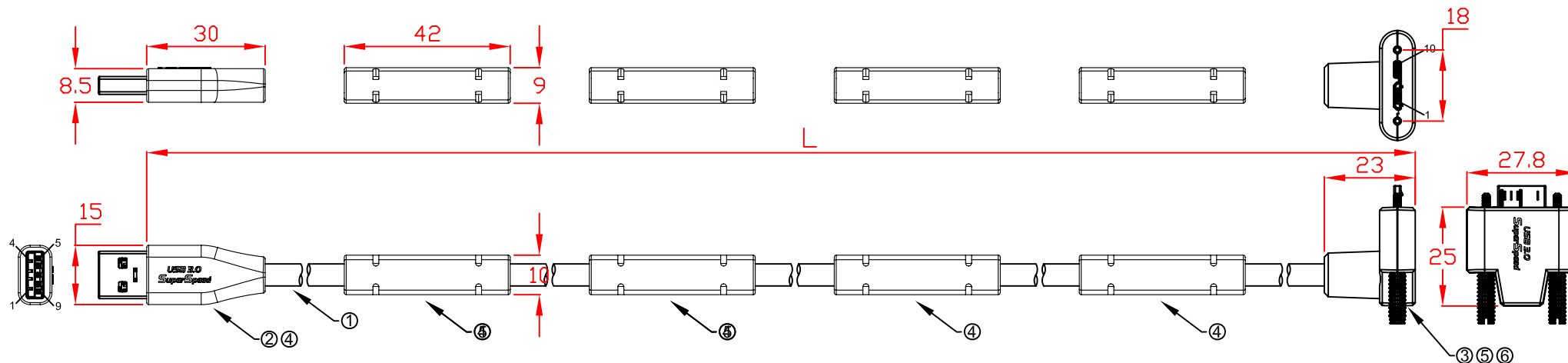

L:
 CBL-ED302MBCSWB-25mDA 25000mm±50mm
 CBL-ED302MBCSWB-30mDA 30000mm±50mm

No	MATERIALS LIST:
1.	CABLE:UL2725 (28AWG*1PR+D+AM)x2C+28AWG*1PR+24AWG*1C+AM+B OD:5.6mm PVC JACKET COLOR:BLACK
2.	CONNECTOR:USB 3.0 A/M, 9P, BLUE INSULATOR SOLDER TYPE, NICKEL PLATED SHELL
3.	CONNECTOR:USB 3.0 MicroB/M, 10P, BLACK INSULATOR SOLDER TYPE, NICKEL PLATED SHELL
4.	PVC MOLDED HOUSING, BLACK COLOR
5.	ABS ASSEMBLY HOUSING, BLACK COLOR
6.	SCREW:#4x33 M2

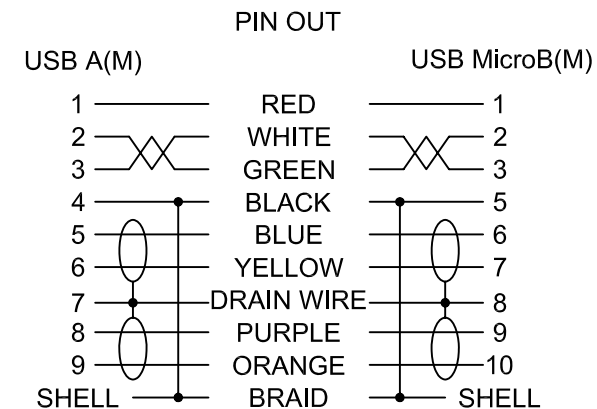

Jargy part no.	Client part no.	Approved	SCALE	UNIT
CBL-ED302MBCSWB-XmDA			1 : 2	mm
Drawing Name		Drawn	Date	REV.
USB 3.0 A to MicroB Cable M/M		<i>Kevin Hsu</i>	2015/08/21	1.0

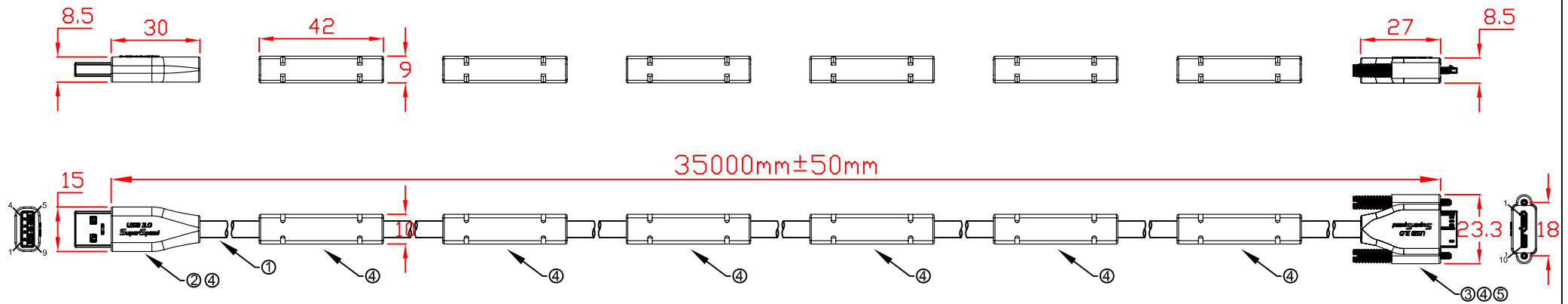

CBL-ED302MBCSWB-35m 35000mm±50mm

No	MATERIALS LIST:
1.	CABLE:UL2725 (28AWG*1PR+D+AM)x2C+28AWG*1PR+24AWG*1C+AM+B OD:5.6mm PVC JACKET COLOR:BLACK
2.	CONNECTOR:USB 3.0 A/M, 9P, BLUE INSULATOR SOLDER TYPE, NICKEL PLATED SHELL
3.	CONNECTOR:USB 3.0 MicroB/M, 10P, BLACK INSULATOR SOLDER TYPE, NICKEL PLATED SHELL
4.	PVC MOLDED HOUSING, BLACK COLOR
5.	SCREW:#4x33 M2

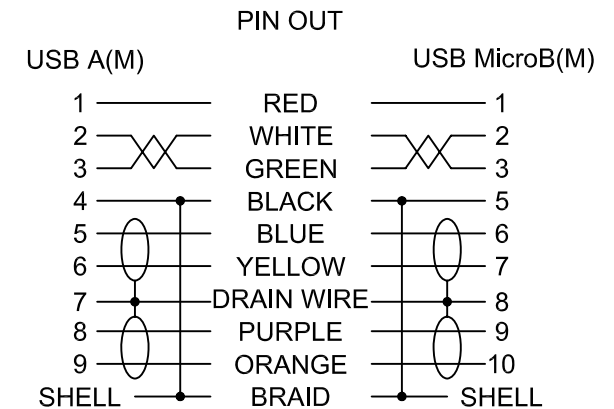

Jargy part no.	Client part no.	Approved	SCALE	UNIT
CBL-ED302MBCSWB-35m			1 : 2	mm
Drawing Name		Drawn	Date	REV.
35m USB 3.0 A to MicroB Cable M/M		<i>Kevin Hsu</i>	2015/08/14	1.0

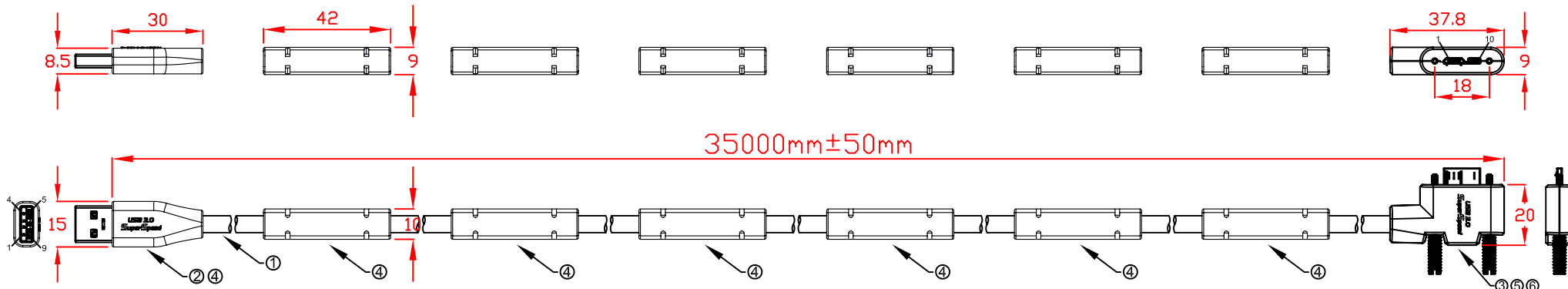

L:
CBL-ED302MBCSWB-35mLA 35000mm±50mm

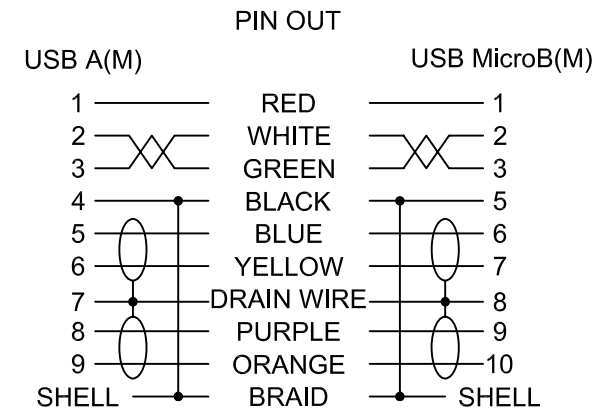

No	MATERIALS LIST:
1.	CABLE:UL2725 (28AWG*1PR+D+AM)x2C+28AWG*1PR+24AWG*1C+AM+B OD:5.6mm PVC JACKET COLOR:BLACK
2.	CONNECTOR:USB 3.0 A/M, 9P, BLUE INSULATOR SOLDER TYPE, NICKEL PLATED SHELL
3.	CONNECTOR:USB 3.0 MicroB/M, 10P, BLACK INSULATOR SOLDER TYPE, NICKEL PLATED SHELL
4.	PVC MOLDED HOUSING, BLACK COLOR
5.	ABS ASSEMBLY HOUSING, BLACK COLOR
6.	SCREW:#4x33 M2

Jargy part no.	Client part no.	Approved	SCALE	UNIT
CBL-ED302MBCSWB-35mLA			1 : 2	mm
Drawing Name		Drawn	Date	REV.
35m USB 3.0 A to MicroB Cable M/M		<i>Kevin Hsu</i>	2015/08/21	1.0

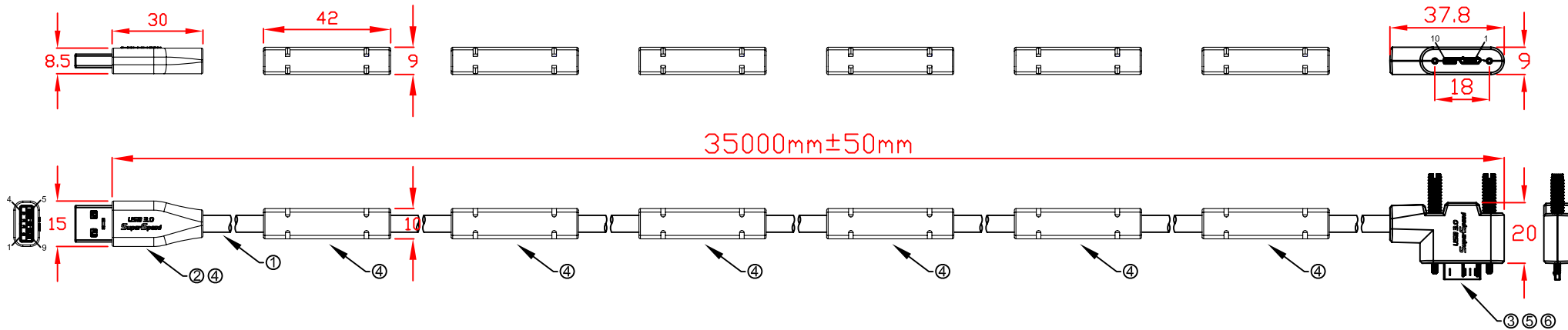

L:
CBL-ED302MBCSWB-35mRA 35000mm±50mm

No	MATERIALS LIST:
1.	CABLE:UL2725 (28AWG*1PR+D+AM)x2C+28AWG*1PR+24AWG*1C+AM+B OD:5.6mm PVC JACKET COLOR:BLACK
2.	CONNECTOR:USB 3.0 A/M, 9P, BLUE INSULATOR SOLDER TYPE, NICKEL PLATED SHELL
3.	CONNECTOR:USB 3.0 MicroB/M, 10P, BLACK INSULATOR SOLDER TYPE, NICKEL PLATED SHELL
4.	PVC MOLDED HOUSING, BLACK COLOR
5.	ABS ASSEMBLY HOUSING, BLACK COLOR
6.	SCREW:#4x33 M2

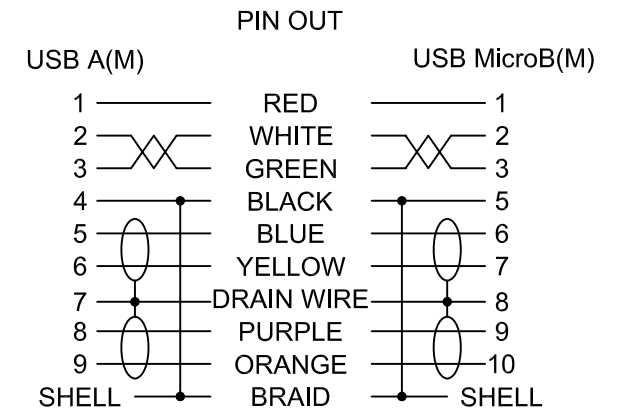

Jargy part no.	Client part no.	Approved	SCALE	UNIT
CBL-ED302MBCSWB-35mRA			1 : 2	mm
Drawing Name		Drawn	Date	REV.
35m USB 3.0 A to MicroB Cable M/M		<i>Kevin Hsu</i>	2015/08/21	1.0

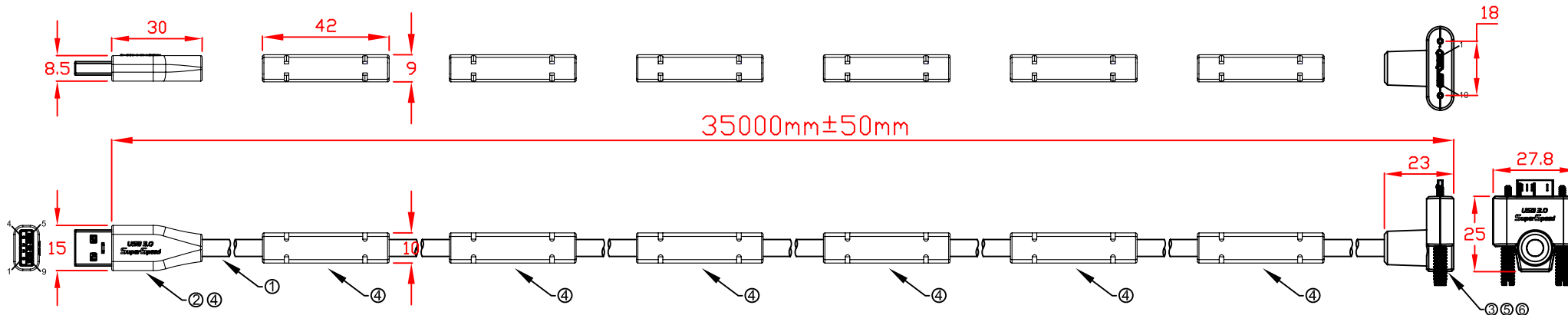

L:
CBL-ED302MBCSWB-35mUA 35000mm±50mm

No	MATERIALS LIST:
1.	CABLE:UL2725 (28AWG*1PR+D+AM)x2C+28AWG*1PR+24AWG*1C+AM+B OD:5.6mm PVC JACKET COLOR:BLACK
2.	CONNECTOR:USB 3.0 A/M, 9P, BLUE INSULATOR SOLDER TYPE, NICKEL PLATED SHELL
3.	CONNECTOR:USB 3.0 MicroB/M, 10P, BLACK INSULATOR SOLDER TYPE, NICKEL PLATED SHELL
4.	PVC MOLDED HOUSING, BLACK COLOR
5.	ABS ASSEMBLY HOUSING, BLACK COLOR
6.	SCREW:#4x33 M2

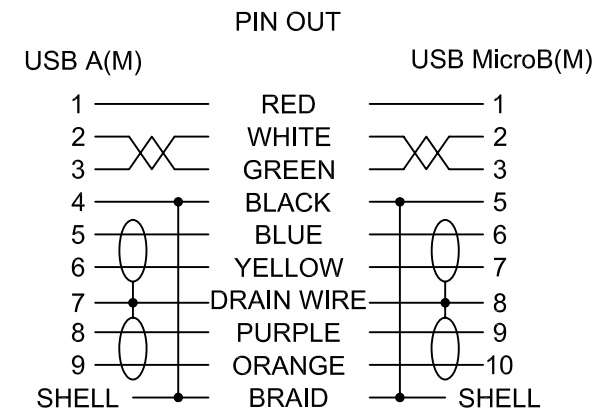

Jargy part no.	Client part no.	Approved	SCALE	UNIT
CBL-ED302MBCSWB-35mUA			1 : 2	mm
Drawing Name		Drawn	Date	REV.
35m USB 3.0 A to MicroB Cable M/M		<i>Kevin Hsu</i>	2015/08/21	1.0



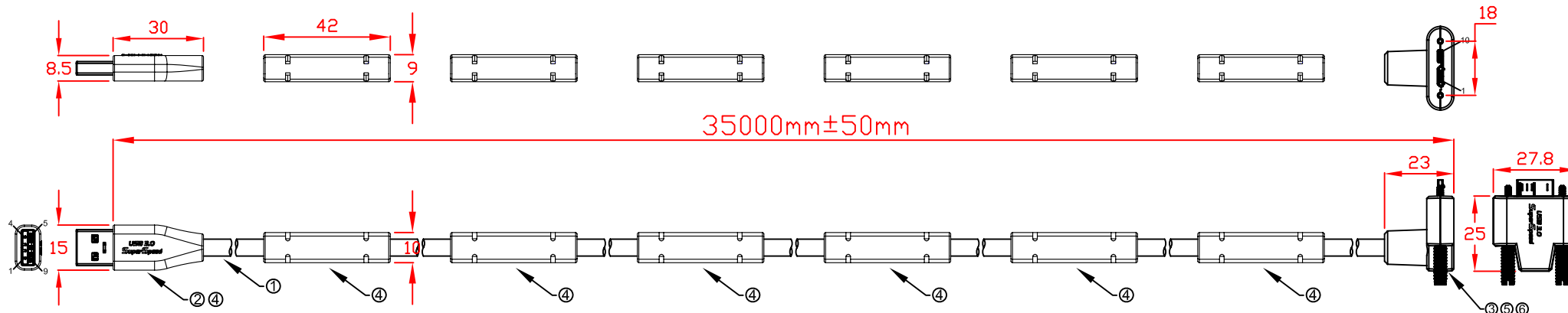

L:
CBL-ED302MBCSWB-35mDA 35000mm±50mm

No	MATERIALS LIST:
1.	CABLE:UL2725 (28AWG*1PR+D+AM)x2C+28AWG*1PR+24AWG*1C+AM+B OD:5.6mm PVC JACKET COLOR:BLACK
2.	CONNECTOR:USB 3.0 A/M, 9P, BLUE INSULATOR SOLDER TYPE, NICKEL PLATED SHELL
3.	CONNECTOR:USB 3.0 MicroB/M, 10P, BLACK INSULATOR SOLDER TYPE, NICKEL PLATED SHELL
4.	PVC MOLDED HOUSING, BLACK COLOR
5.	ABS ASSEMBLY HOUSING, BLACK COLOR
6.	SCREW:#4x33 M2

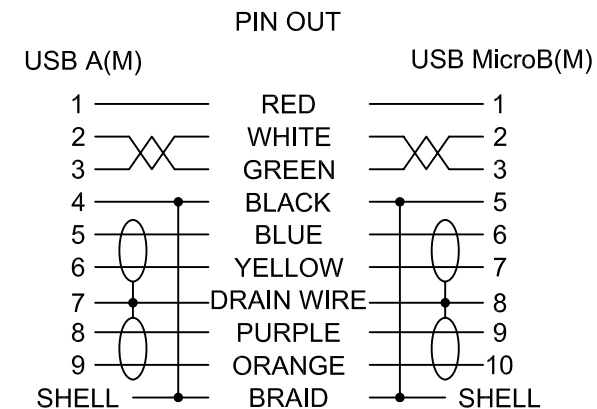

Jargy part no.	Client part no.	Approved	SCALE	UNIT
CBL-ED302MBCSWB-35mDA			1 : 2	mm
Drawing Name		Drawn	Date	REV.
35m USB 3.0 A to MicroB Cable M/M		<i>Kevin Hsu</i>	2015/08/21	1.0



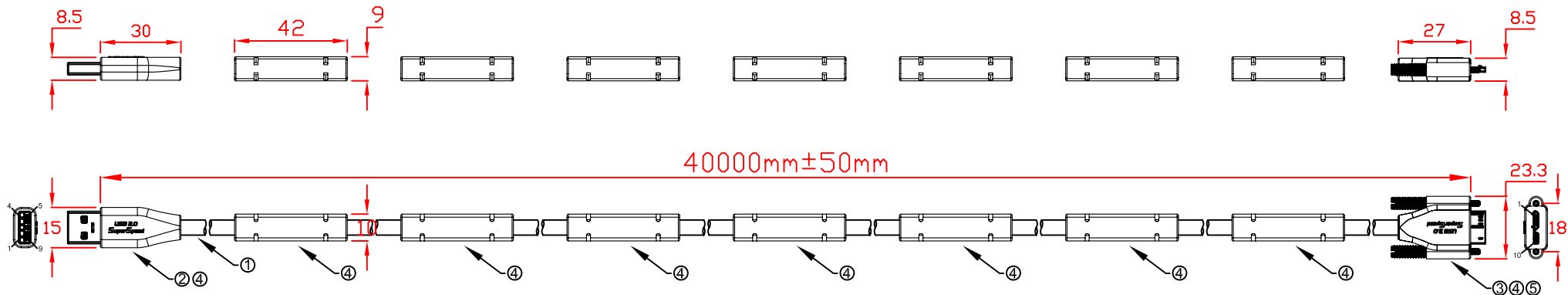

CBL-ED302MBCSWB-40m 40000mm±50mm

No	MATERIALS LIST:
1.	CABLE:UL2725 (28AWG*1PR+D+AM)x2C+28AWG*1PR+24AWG*1C+AM+B OD:5.6mm PVC JACKET COLOR:BLACK
2.	CONNECTOR:USB 3.0 A/M, 9P, BLUE INSULATOR SOLDER TYPE, NICKEL PLATED SHELL
3.	CONNECTOR:USB 3.0 MicroB/M, 10P, BLACK INSULATOR SOLDER TYPE, NICKEL PLATED SHELL
4.	PVC MOLDED HOUSING, BLACK COLOR
5.	SCREW:#4x33 M2

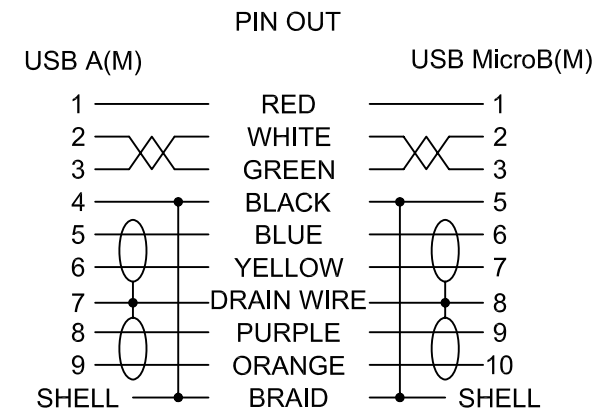

Jargy part no.	Client part no.	Approved	SCALE	UNIT
CBL-ED302MBCSWB-40m			1 : 2	mm
Drawing Name		Drawn	Date	REV.
40m USB 3.0 A to MicroB Cable M/M		<i>Kevin Hsu</i>	2015/08/14	1.0

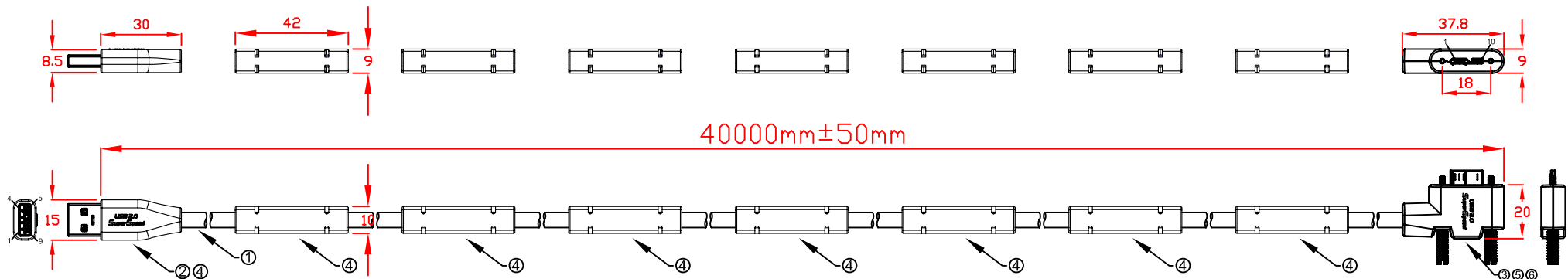

L:
CBL-ED302MBCSWB-40mLA 40000mm±50mm

No	MATERIALS LIST:
1.	CABLE:UL2725 (28AWG*1PR+D+AM)x2C+28AWG*1PR+24AWG*1C+AM+B OD:5.6mm PVC JACKET COLOR:BLACK
2.	CONNECTOR:USB 3.0 A/M, 9P, BLUE INSULATOR SOLDER TYPE, NICKEL PLATED SHELL
3.	CONNECTOR:USB 3.0 MicroB/M, 10P, BLACK INSULATOR SOLDER TYPE, NICKEL PLATED SHELL
4.	PVC MOLDED HOUSING, BLACK COLOR
5.	ABS ASSEMBLY HOUSING, BLACK COLOR
6.	SCREW:#4x33 M2

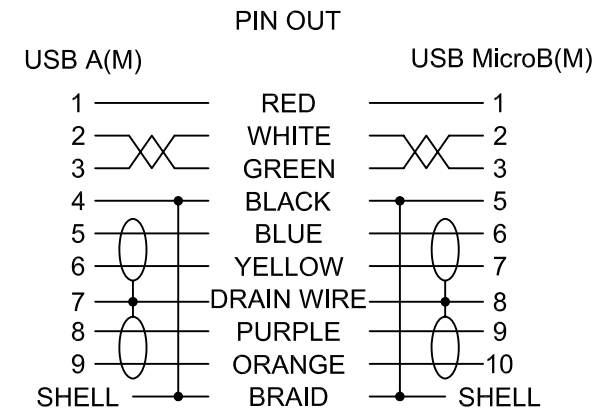

Jargy part no.	Client part no.	Approved	SCALE	UNIT
CBL-ED302MBCSWB-40mLA			1 : 2	mm
Drawing Name		Drawn	Date	REV.
40m USB 3.0 A to MicroB Cable M/M		<i>Kevin Hsu</i>	2015/08/24	1.0

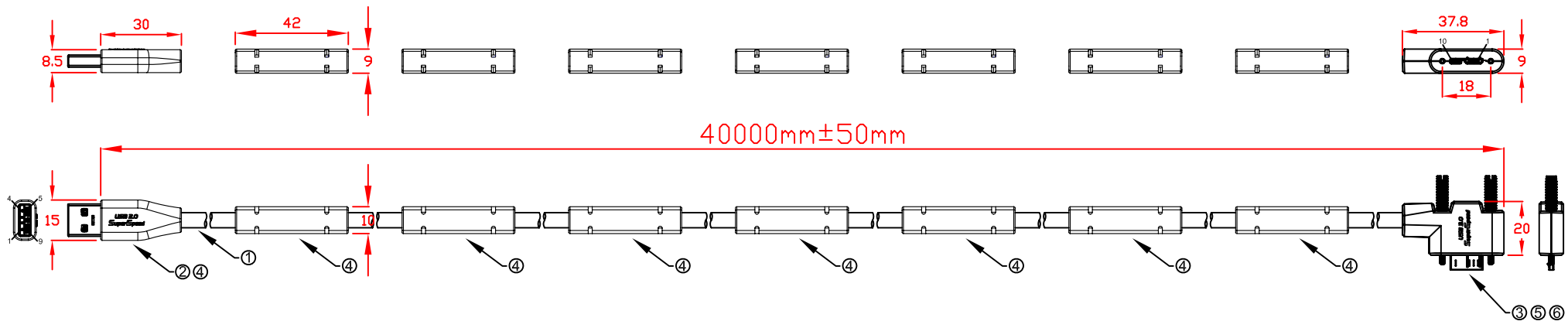

L:
CBL-ED302MBCSWB-40mRA 40000mm±50mm

No	MATERIALS LIST:
1.	CABLE:UL2725 (28AWG*1PR+D+AM)x2C+28AWG*1PR+24AWG*1C+AM+B OD:5.6mm PVC JACKET COLOR:BLACK
2.	CONNECTOR:USB 3.0 A/M, 9P, BLUE INSULATOR SOLDER TYPE, NICKEL PLATED SHELL
3.	CONNECTOR:USB 3.0 MicroB/M, 10P, BLACK INSULATOR SOLDER TYPE, NICKEL PLATED SHELL
4.	PVC MOLDED HOUSING, BLACK COLOR
5.	ABS ASSEMBLY HOUSING, BLACK COLOR
6.	SCREW:#4x33 M2

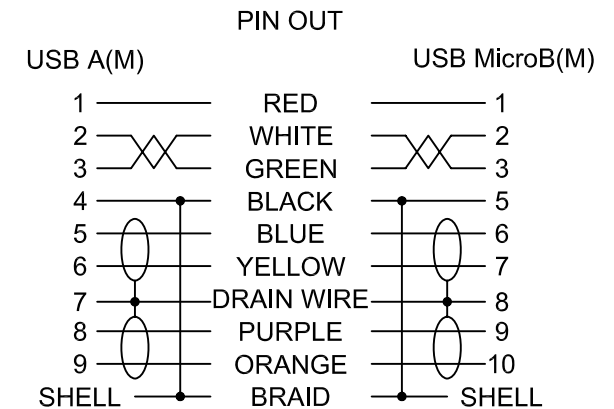

Jargy part no.	Client part no.	Approved	SCALE	UNIT
CBL-ED302MBCSWB-40mRA			1 : 2	mm
Drawing Name		Drawn	Date	REV.
40m USB 3.0 A to MicroB Cable M/M		<i>Kevin Hsu</i>	2015/08/24	1.0

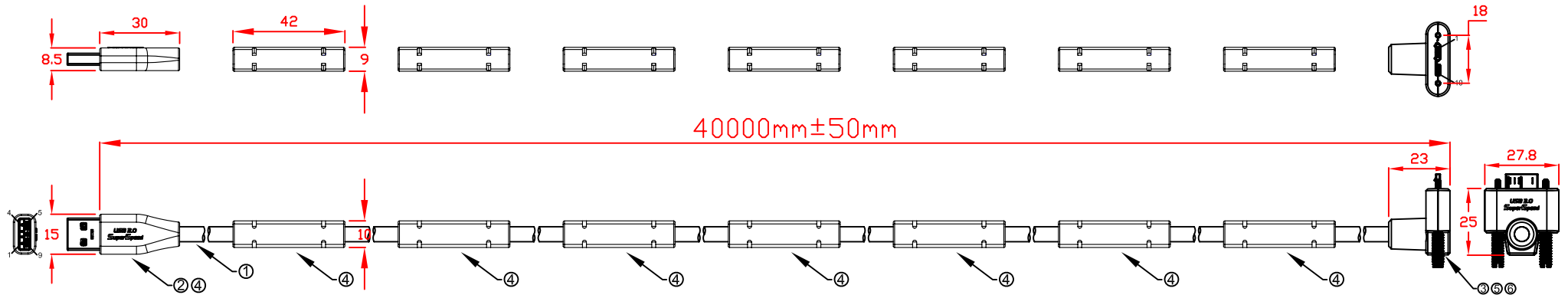

L:
CBL-ED302MBCSWB-40mUA 40000mm±50mm

No	MATERIALS LIST:
1.	CABLE:UL2725 (28AWG*1PR+D+AM)x2C+28AWG*1PR+24AWG*1C+AM+B OD:5.6mm PVC JACKET COLOR:BLACK
2.	CONNECTOR:USB 3.0 A/M, 9P, BLUE INSULATOR SOLDER TYPE, NICKEL PLATED SHELL
3.	CONNECTOR:USB 3.0 MicroB/M, 10P, BLACK INSULATOR SOLDER TYPE, NICKEL PLATED SHELL
4.	PVC MOLDED HOUSING, BLACK COLOR
5.	ABS ASSEMBLY HOUSING, BLACK COLOR
6.	SCREW:#4x33 M2

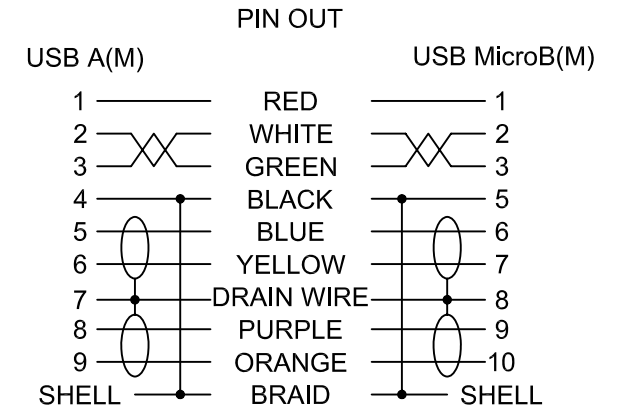

Jargy part no.	Client part no.	Approved	SCALE	UNIT
CBL-ED302MBCSWB-40mUA			1 : 2	mm
Drawing Name		Drawn	Date	REV.
40m USB 3.0 A to MicroB Cable M/M		<i>Kevin Hsu</i>	2015/08/24	1.0

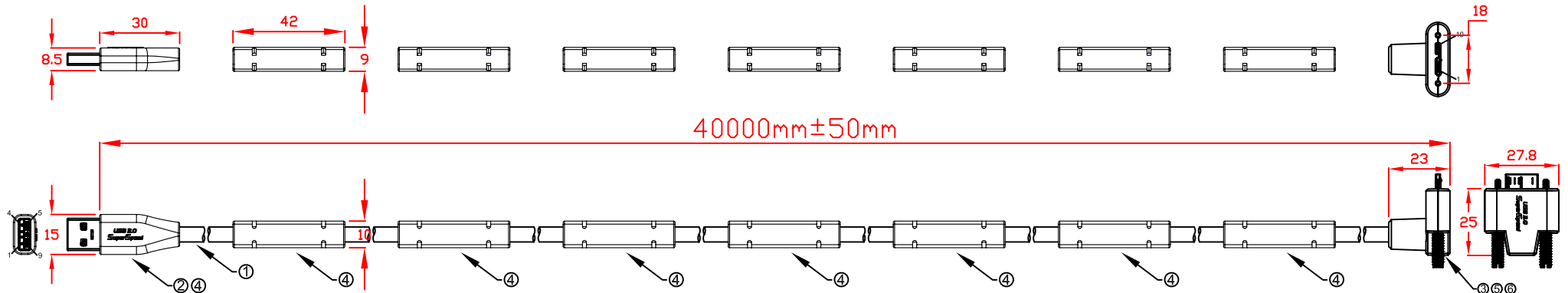

L:
CBL-ED302MBCSWB-40mDA 40000mm±50mm

No	MATERIALS LIST:
1.	CABLE:UL2725 (28AWG*1PR+D+AM)x2C+28AWG*1PR+24AWG*1C+AM+B OD:5.6mm PVC JACKET COLOR:BLACK
2.	CONNECTOR:USB 3.0 A/M, 9P, BLUE INSULATOR SOLDER TYPE, NICKEL PLATED SHELL
3.	CONNECTOR:USB 3.0 MicroB/M, 10P, BLACK INSULATOR SOLDER TYPE, NICKEL PLATED SHELL
4.	PVC MOLDED HOUSING, BLACK COLOR
5.	ABS ASSEMBLY HOUSING, BLACK COLOR
6.	SCREW:#4x33 M2

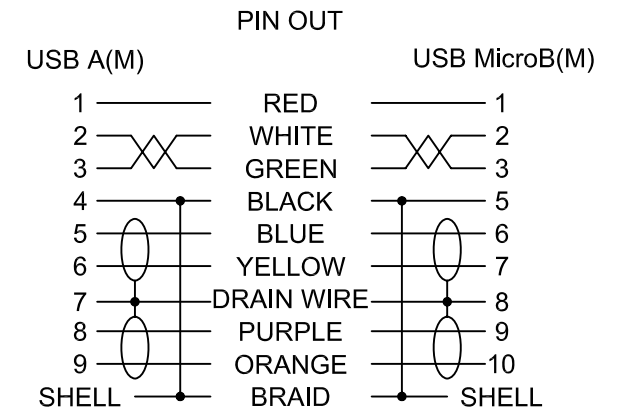

Jargy part no.	Client part no.	Approved	SCALE	UNIT
CBL-ED302MBCSWB-40mDA			1 : 2	mm
Drawing Name		Drawn	Date	REV.
40m USB 3.0 A to MicroB Cable M/M		<i>Kevin Hsu</i>	2015/08/24	1.0

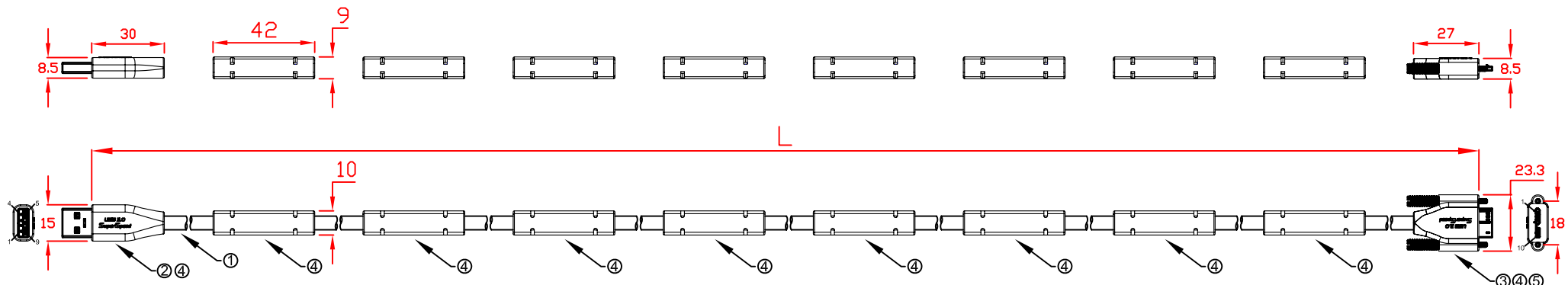

L:
 CBL-ED302MBCSWB-45m 45000mm±50mm
 CBL-ED302MBCSWB-50m 50000mm±50mm

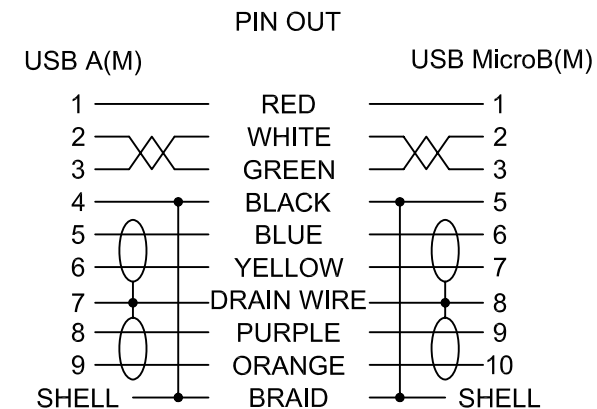

No	MATERIALS LIST:
1.	CABLE:UL2725 (28AWG*1PR+D+AM)x2C+28AWG*1PR+24AWG*1C+AM+B OD:5.6mm PVC JACKET COLOR:BLACK
2.	CONNECTOR:USB 3.0 A/M, 9P, BLUE INSULATOR SOLDER TYPE, NICKEL PLATED SHELL
3.	CONNECTOR:USB 3.0 MicroB/M, 10P, BLACK INSULATOR SOLDER TYPE, NICKEL PLATED SHELL
4.	PVC MOLDED HOUSING, BLACK COLOR
5.	SCREW:#4x33 M2

Jargy part no.	Client part no.	Approved	SCALE	UNIT
CBL-ED302MBCSWB-Xm			1 : 2	mm
Drawing Name		Drawn	Date	REV.
USB 3.0 A to MicroB Cable M/M		<i>Kevin Hsu</i>	2015/08/14	1.0

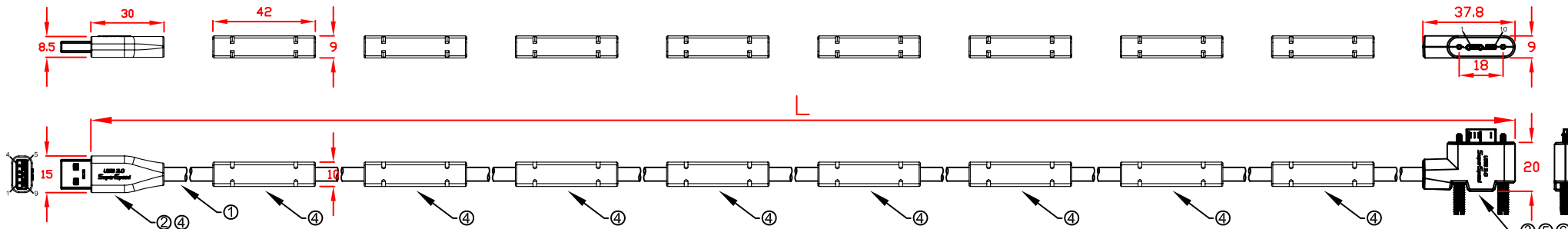

L:
 CBL-ED302MBCSWB-45mLA 45000mm±50mm
 CBL-ED302MBCSWB-50mLA 50000mm±50mm

No	MATERIALS LIST:
1.	CABLE:UL2725 (28AWG*1PR+D+AM)x2C+28AWG*1PR+24AWG*1C+AM+B OD:5.6mm PVC JACKET COLOR:BLACK
2.	CONNECTOR:USB 3.0 A/M, 9P, BLUE INSULATOR SOLDER TYPE, NICKEL PLATED SHELL
3.	CONNECTOR:USB 3.0 MicroB/M, 10P, BLACK INSULATOR SOLDER TYPE, NICKEL PLATED SHELL
4.	PVC MOLDED HOUSING, BLACK COLOR
5.	ABS ASSEMBLY HOUSING, BLACK COLOR
6.	SCREW:#4x33 M2

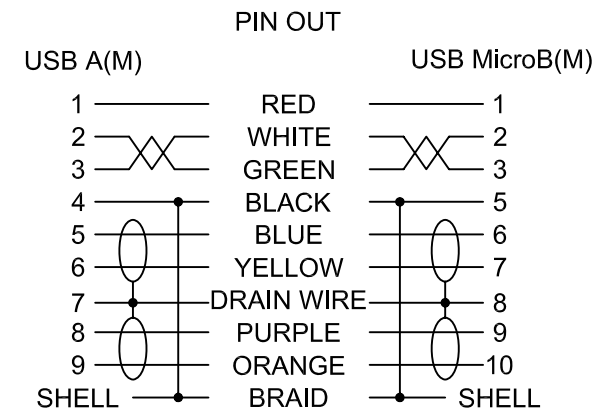

Jargy part no.	Client part no.	Approved	SCALE	UNIT
CBL-ED302MBCSWB-XmLA			1 : 2	mm
Drawing Name		Drawn	Date	REV.
USB 3.0 A to MicroB Cable M/M		<i>Kevin Hsu</i>	2015/08/24	1.0

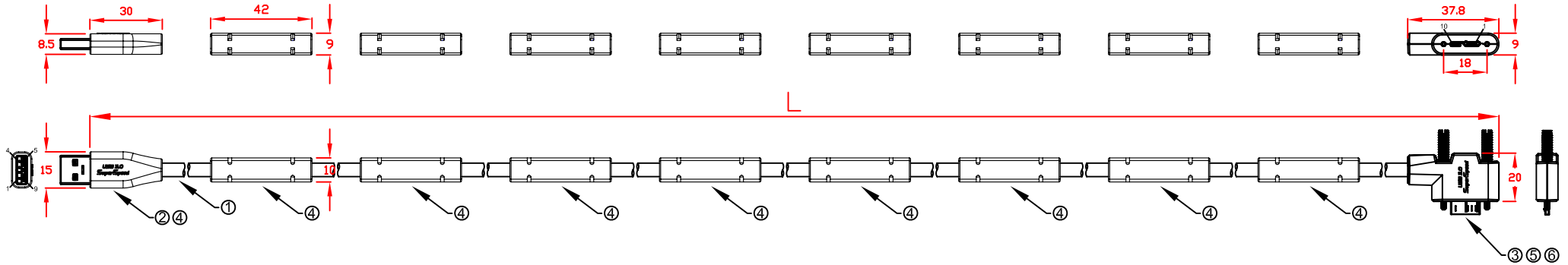

L:
 CBL-ED302MBCSWB-45mRA 45000mm±50mm
 CBL-ED302MBCSWB-50mRA 50000mm±50mm

No	MATERIALS LIST:
1.	CABLE:UL2725 (28AWG*1PR+D+AM)x2C+28AWG*1PR+24AWG*1C+AM+B OD:5.6mm PVC JACKET COLOR:BLACK
2.	CONNECTOR:USB 3.0 A/M, 9P, BLUE INSULATOR SOLDER TYPE, NICKEL PLATED SHELL
3.	CONNECTOR:USB 3.0 MicroB/M, 10P, BLACK INSULATOR SOLDER TYPE, NICKEL PLATED SHELL
4.	PVC MOLDED HOUSING, BLACK COLOR
5.	ABS ASSEMBLY HOUSING, BLACK COLOR
6.	SCREW:#4x33 M2

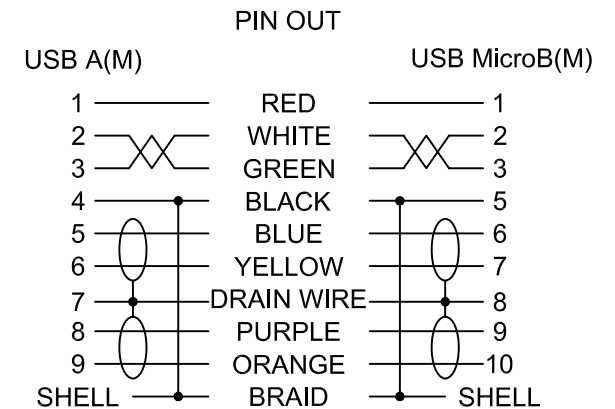

Jargy part no.	Client part no.	Approved	SCALE	UNIT
CBL-ED302MBCSWB-XmRA			1 : 2	mm
Drawing Name		Drawn	Date	REV.
USB 3.0 A to MicroB Cable M/M		<i>Kevin Hsu</i>	2015/08/24	1.0

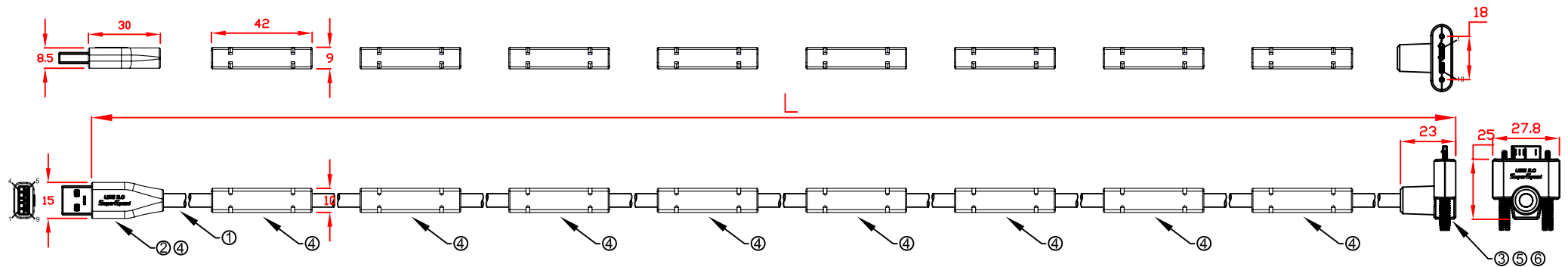

L:
 CBL-ED302MBCSWB-45mUA 45000mm±50mm
 CBL-ED302MBCSWB-50mUA 50000mm±50mm

No	MATERIALS LIST:
1.	CABLE:UL2725 (28AWG*1PR+D+AM)x2C+28AWG*1PR+24AWG*1C+AM+B OD:5.6mm PVC JACKET COLOR:BLACK
2.	CONNECTOR:USB 3.0 A/M, 9P, BLUE INSULATOR SOLDER TYPE, NICKEL PLATED SHELL
3.	CONNECTOR:USB 3.0 MicroB/M, 10P, BLACK INSULATOR SOLDER TYPE, NICKEL PLATED SHELL
4.	PVC MOLDED HOUSING, BLACK COLOR
5.	ABS ASSEMBLY HOUSING, BLACK COLOR
6.	SCREW:#4x33 M2

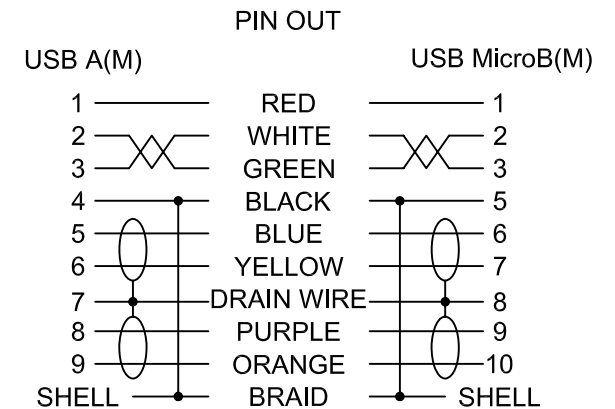

Jargy part no.	Client part no.	Approved	SCALE	UNIT
CBL-ED302MBCSWB-XmUA			1 : 2	mm
Drawing Name		Drawn	Date	REV.
USB 3.0 A to MicroB Cable M/M		<i>Kevin Hsu</i>	2015/08/24	1.0

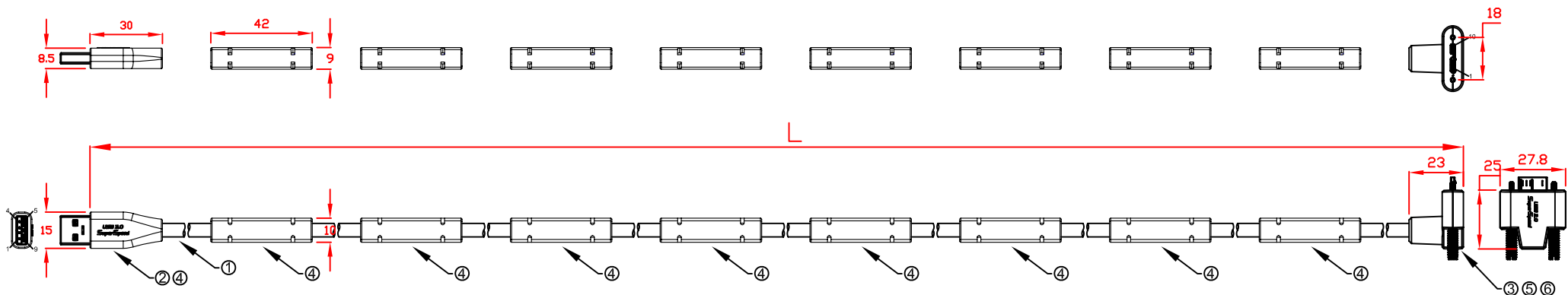

L:
 CBL-ED302MBCSWB-45mDA 45000mm±50mm
 CBL-ED302MBCSWB-50mDA 50000mm±50mm

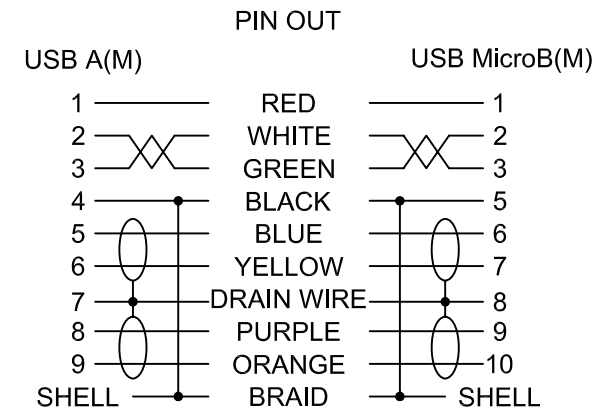

No	MATERIALS LIST:
1.	CABLE:UL2725 (28AWG*1PR+D+AM)x2C+28AWG*1PR+24AWG*1C+AM+B OD:5.6mm PVC JACKET COLOR:BLACK
2.	CONNECTOR:USB 3.0 A/M, 9P, BLUE INSULATOR SOLDER TYPE, NICKEL PLATED SHELL
3.	CONNECTOR:USB 3.0 MicroB/M, 10P, BLACK INSULATOR SOLDER TYPE, NICKEL PLATED SHELL
4.	PVC MOLDED HOUSING, BLACK COLOR
5.	ABS ASSEMBLY HOUSING, BLACK COLOR
6.	SCREW:#4x33 M2

Jargy part no.	Client part no.	Approved	SCALE	UNIT
CBL-ED302MBCSWB-XmDA			1 : 2	mm
Drawing Name		Drawn	Date	REV.
USB 3.0 A to MicroB Cable M/M		<i>Kevin Hsu</i>	2015/08/24	1.0